

APPENDIX A

Field Sampling Logs

Discrete Surface Soil Samples
Incremental Sampling Method Surface Soil Samples
Soil Boring Samples
Surface Water and Sediment Samples

THIS PAGE INTENTIONALLY LEFT BLANK.

DISCRETE SURFACE SOIL SAMPLES

THIS PAGE INTENTIONALLY LEFT BLANK.

HTRW DRILLING LOG		DISTRICT USACE - Louisville	BOREHOLE NUMBER WSA SS-030
1. COMPANY NAME SAIC		2. DRILLING SUBCONTRACTOR NA	SHEET 1 OF 1

3. PROJECT RVAAP PBA08 RI	4. LOCATION RVAAP 8451 State Route 5 Ravenna, OH 44266
5. NAME OF DRILLER STEVE WISSECKY — MIKE DENARD	6. DIRECTION OF BOREHOLE <input checked="" type="checkbox"/> VERTICAL <input type="checkbox"/> INCLINED DEGREES
7. NOTES PID MAKE/MODEL: NA WATER LEVEL MAKE/MODEL: NA	PID SERIAL#: NA Colors from Munsell Soil Color Chart, Rev 1994 WATER LEVEL SERIAL#: NA

ELEVATION	DEPTH (Feet)	USCS	CLASSIFICATION OF MATERIALS	SPT DATA (0.5 Feet)	MONITORING (PPM/CPM)	REMARKS (Sample IDs/Depths/Core Box/Etc.)
		ML	3H silt SILT, fine sand (30%), little clay, trace gravel and organics (roots), gray 2.5Y 5/1, mottled dark yellowish brown 10YR 4/6, soft, damp, low plasticity, no odors.	Hand auger 0-1'	NA	11 00 WSA SS 030-5653-00 Total Cr Hex Cr
1			Rem Terminated boring at 1'. BORING COMPLETE USING A 3" SS HAND AUGER			

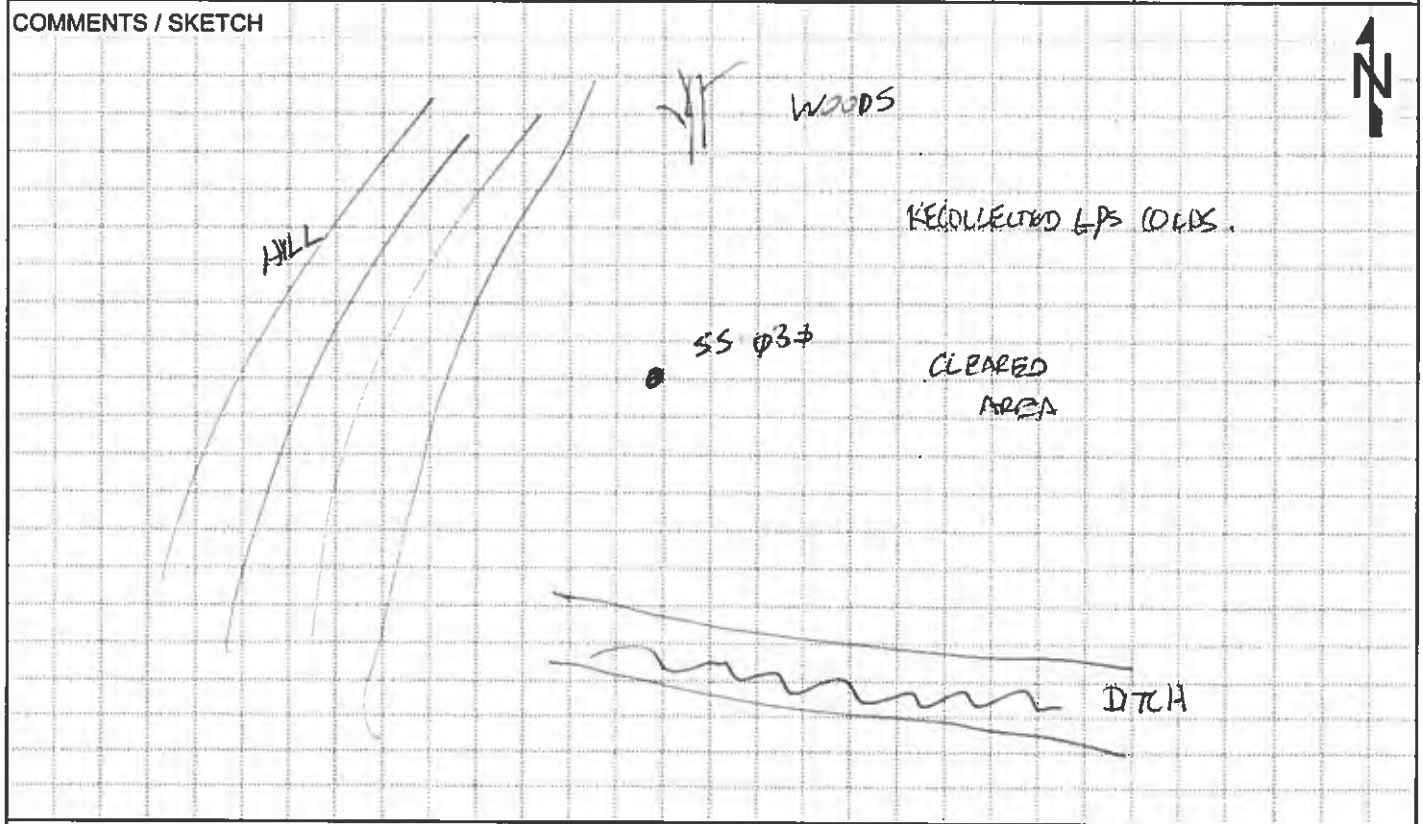

GEOLOGIST SIGNATURE/DATE [Signature] 3/24/10	QA/QC SIGNATURE/DATE [Signature] 03/24/10	BOREHOLE NUMBER WSA SS-030
---	--	-------------------------------

HTRW DRILLING LOG		DISTRICT USACE - Louisville	BOREHOLE NUMBER WSA ss ϕ 31
1. COMPANY NAME SAIC		2. DRILLING SUBCONTRACTOR NA	SHEET 1 OF 1
3. PROJECT RVAAP PBA08 RI		4. LOCATION RVAAP 8451 State Route 5 Ravenna, OH 44266	
5. NAME OF DRILLER STEVE VISOCKY		6. DIRECTION OF BOREHOLE <input checked="" type="checkbox"/> VERTICAL <input type="checkbox"/> INCLINED DEGREES	
7. NOTES PID MAKE/MODEL: MA WATER LEVEL MAKE/MODEL: MA		PID SERIAL# NA Colors from Munsell Soil Color Chart, Rev 1/49	

ELEVATION	DEPTH (Feet)	USCS	CLASSIFICATION OF MATERIALS	SPT DATA (0.5 Feet)	MONITORING (PPM/CPM)	REMARKS (Sample IDs/Depths/Core Box/Etc.)
		ML	SILT, little clay, trace sand, fine sand, Angular, light brownish-grey 1 ϕ YR 6/2, soft, moist, low plasticity, mottled brownish-yellow 1 ϕ YR 6/8, trace organics (roots), ϕ - ϕ .2' dark grey, gley 4, SILT.	Hand auger ϕ -1'	MA	11 ϕ 5 WSA ss ϕ 31-SB371-50 Total Cr Hex Cr
	1		Terminated boring + 1' fat.			
BORING COMPLETE USING A 3" SS HAND AUGER						

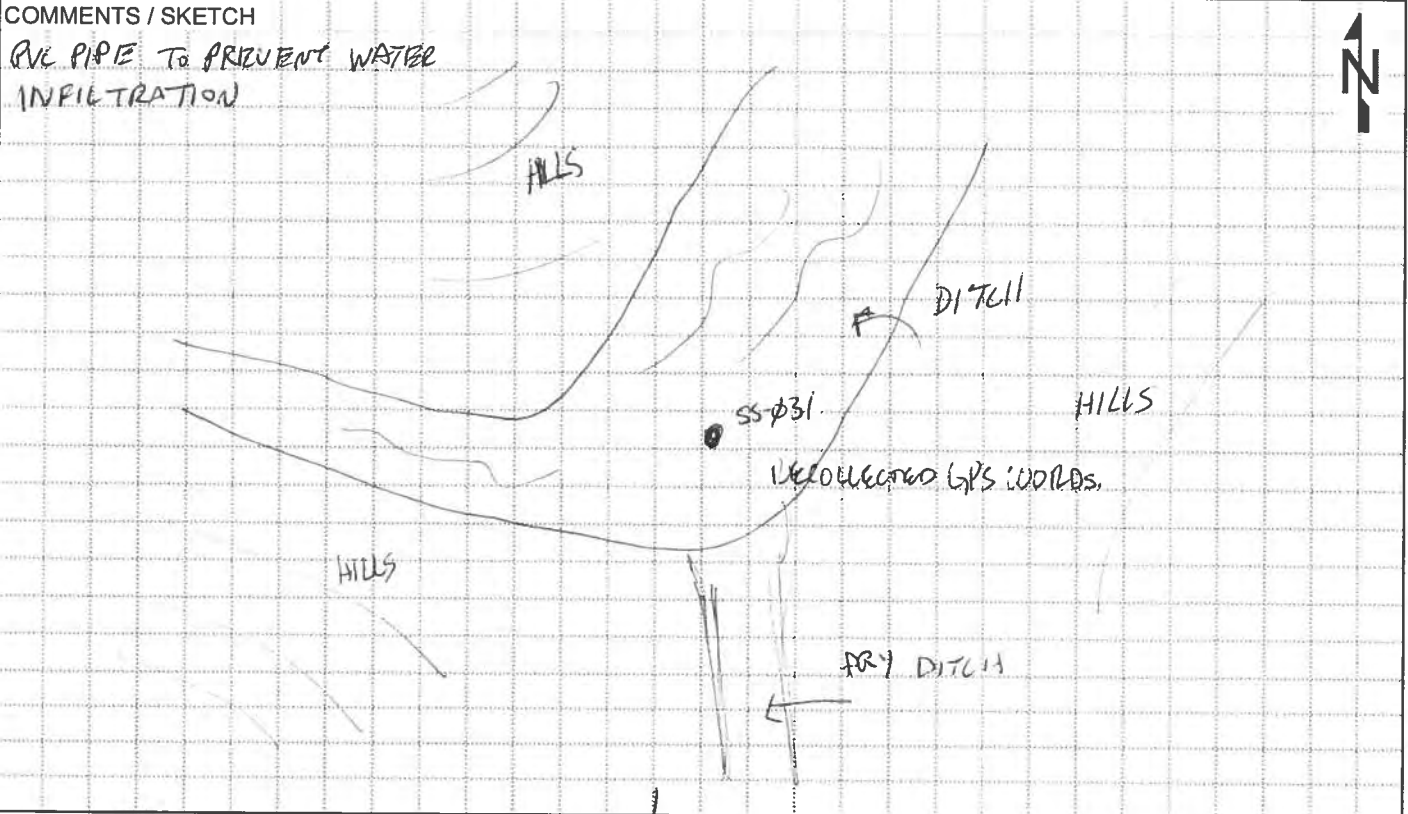

GEOLOGIST SIGNATURE/DATE <i>Steve Visocky</i> 3/24/10	QA/QC SIGNATURE/DATE <i>[Signature]</i> 03/31/2010	BOREHOLE NUMBER WSA ss ϕ 31
--	---	-------------------------------------

HTRW DRILLING LOG

DISTRICT
USACE - Louisville

BOREHOLE NUMBER
WSA SS-032

1. COMPANY NAME
SAIC

2. DRILLING SUBCONTRACTOR
NA

SHEET 1 OF 1

3. PROJECT
RVAAP PBA 08 RT

4. LOCATION
RVAAP 8451 State Route 5 Ravenna, OH 44266

5. NAME OF DRILLER
STEVE VISOCKY

6. DIRECTION OF BOREHOLE
 VERTICAL INCLINED DEGREES

7. NOTES
PID MAKE/MODEL: NA PID SERIAL#: NA Colors from Munsell Soil Color Chart, Rev 1/99
WATER LEVEL MAKE/MODEL: NA WATER LEVEL SERIAL#: NA

ELEVATION	DEPTH (Feet)	USCS	CLASSIFICATION OF MATERIALS	SPT DATA (0.5 Feet)	MONITORING (PPM/CPM)	REMARKS (Sample IDs/Depths/Core Box/Etc.)
		SC	SILT (SC), little sand, trace gravel, Angular, +++ light olive brown 2.5 YR (8/3), soft, moist, low plasticity, sly, trace organics (roots); mottled dark yellowish brown 10 YR 4/6	Hand auger 0-1'	NA	1 φ 1 φ WSA SS-032-5655-SD Total Cr Hex Cr
			- φ.8' sandstone fragments, iron stained, weak, red YR 4/4			
			Terminated boring at one foot BORING COMPLETE USING A 3" SS HAND AUGER			

COMMENTS / SKETCH

WATER IN BOREHOLE 8" BGS

GEOLOGIST SIGNATURE/DATE
[Signature] 3/24/10

QA/QC SIGNATURE/DATE
[Signature] 03/24/10

BOREHOLE NUMBER
WSA SS-032

THIS PAGE INTENTIONALLY LEFT BLANK.

**INCREMENTAL SAMPLING METHOD (ISM)
(FORMERLY MULTI-INCREMENTAL)
SURFACE SOIL SAMPLES**

THIS PAGE INTENTIONALLY LEFT BLANK.



RVAAP - Multi-Incremental (MI) Field Form

SHEET 1 OF 1

USACE - Louisville

RVAAP 8451 State Rt. 5
Ravenna, OH 442661. Sample Team: MIKE DENALLO
RYAN LAURICH

2. Location ID:

WSA55-φ33M

3. Revised Coordinates Recorded:

NA

4. Sample ID:

WSA55-φ33M-5645-50

5. Sample Date and Time:

03/24/10, 1640

6. Dupe ID:

NA

7. Split ID:

NA9/1 split

8. MI Equipment Used:

PUSH PROBE, BOWL

9. MS/MSD Collected:

WSA55-φ33M-5645-50

10. Activities in the Area:

NONE

11. Soil Description and Field Notes:

SC, SILT, little sand, trace clay, trace gravel, fine sand, greyish brown 1P4R 5/2 to dark greyish brown 1P4R 4/2, soft, damp, low plasticity, mottled brownish yellow 1P4R 6/6, trace organics (roots)

90% wooded 10% open field

12. Location Sketch/Comments (not to scale):

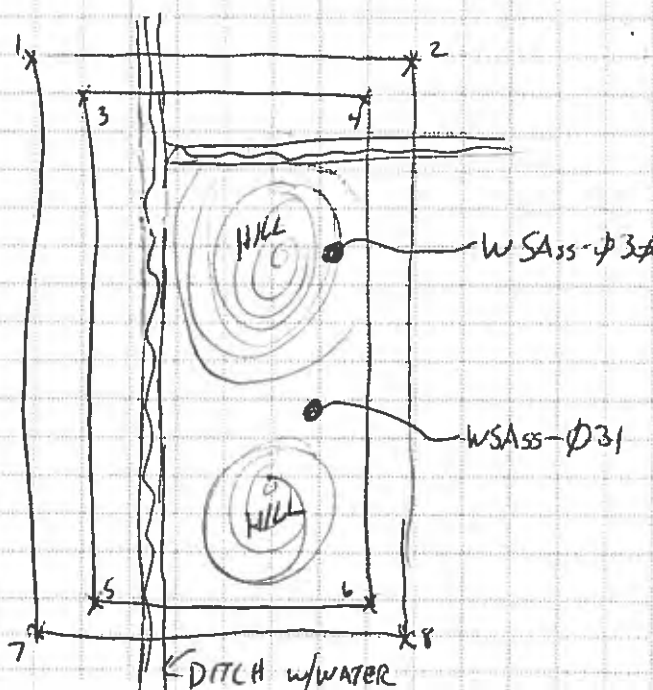

13. MI Soil Analyses:

- EXPLOSIVES TAL METALS SVOCs PAHs OTHER _____
 FULL SUITE (VOCs, SVOCs, Metals, Explosives, Propellants, Pesticides, PCBs)

Recorded By:

S-f Nish 03/24/10
(Signature and Date)

QC Checked By:

Se Nish 3/24/10
(Signature and Date)



RVAAP - Multi-Incremental (MI) Field Form

SHEET 1 OF 1

USACE - Louisville
RVAAP PBA 2008 RIRVAAP 8451 State Rt. 5
Ravenna, OH 442661. Sample Team: STEVE VISOCKY
SARA HISE

2. Location ID: WSA _{ss} -Ø34M	3. Revised Coordinates Recorded: NA
4. Sample ID: WSA _{ss} -Ø34M-5646-50	5. Sample Date and Time: Ø3/24/1Ø, 16ØØ
6. Dupe ID: WSA _{ss} -Ø34M-6195-FD	7. Split ID: WSA _{ss} -Ø34M-6194-QA
8. MI Equipment Used: PUSH PROBE, BOWL	9. MS/MSD Collected: NA
	10. Activities in the Area: NONE

11. Soil Description and Field Notes: ML, SILT, little fine sand, trace clay, trace gravel, greyish brown, 1ØYR 5/2, soft, damp, low plasticity, mottled 1ØYR 1/8 yellowish-brown, trace organics (roots)

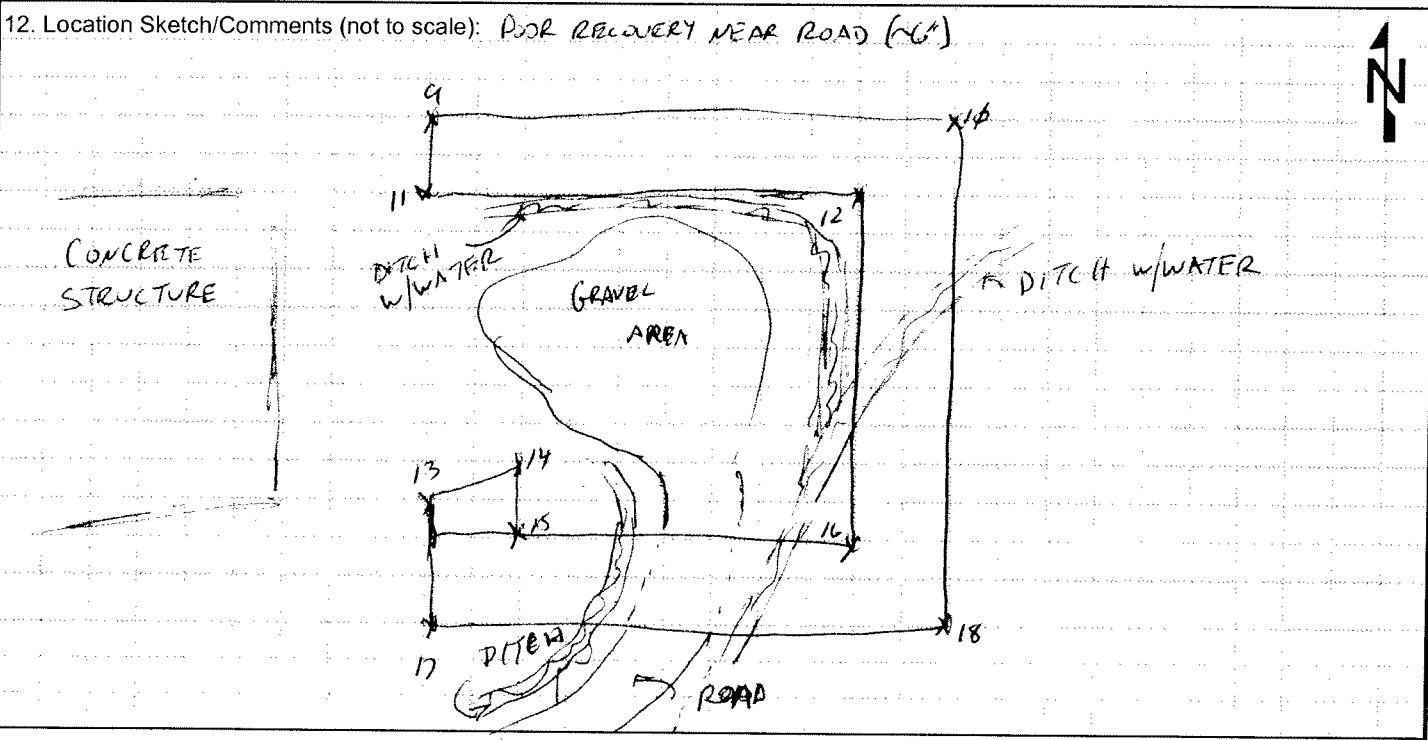

13. MI Soil Analyses:

EXPLOSIVES
 TAL METALS
 SVOCs
 PAHs
 OTHER _____
 FULL SUITE (VOCs, SVOCs, Metals, Explosives, Propellants, Pesticides, PCBs)

Recorded By: Steve Visocky 03/24/1Ø (Signature and Date)

QC Checked By: Steve Visocky 3/24/1Ø (Signature and Date)



RVAAP - Multi-Incremental (MI) Field Form

SHEET 1 OF 1

USACE - Louisville

RVAAP 8451 State Rt. 5
Ravenna, OH 442661. Sample Team: STEVE VISOCKY
SARA HIDE

2. Location ID

WSA₃₅ - Ø35M

3. Revised Coordinates Recorded:

NA

4. Sample ID

WSA₃₅ - Ø35M - 5648 - 50

5. Sample Date and Time:

03/24/14, 1434

6. Dupe ID

NA

7. Split ID

NA

8. MI Equipment Used:

PUSH PROBE, BOWL

9. MS/MSD Collected: NA

10. Activities in the Area: NONE

11. Soil Description and Field Notes:

ML, SILT, trace clay trace sand (fine), greyish brown 10YR 5/2, soft, damp, ~~non-plastic~~ low plasticity, trace organics (roots), mottled yellowish brown 10YR 5/6.

30% wooded 60% Brush 10% open Area

12. Location Sketch/Comments (not to scale):

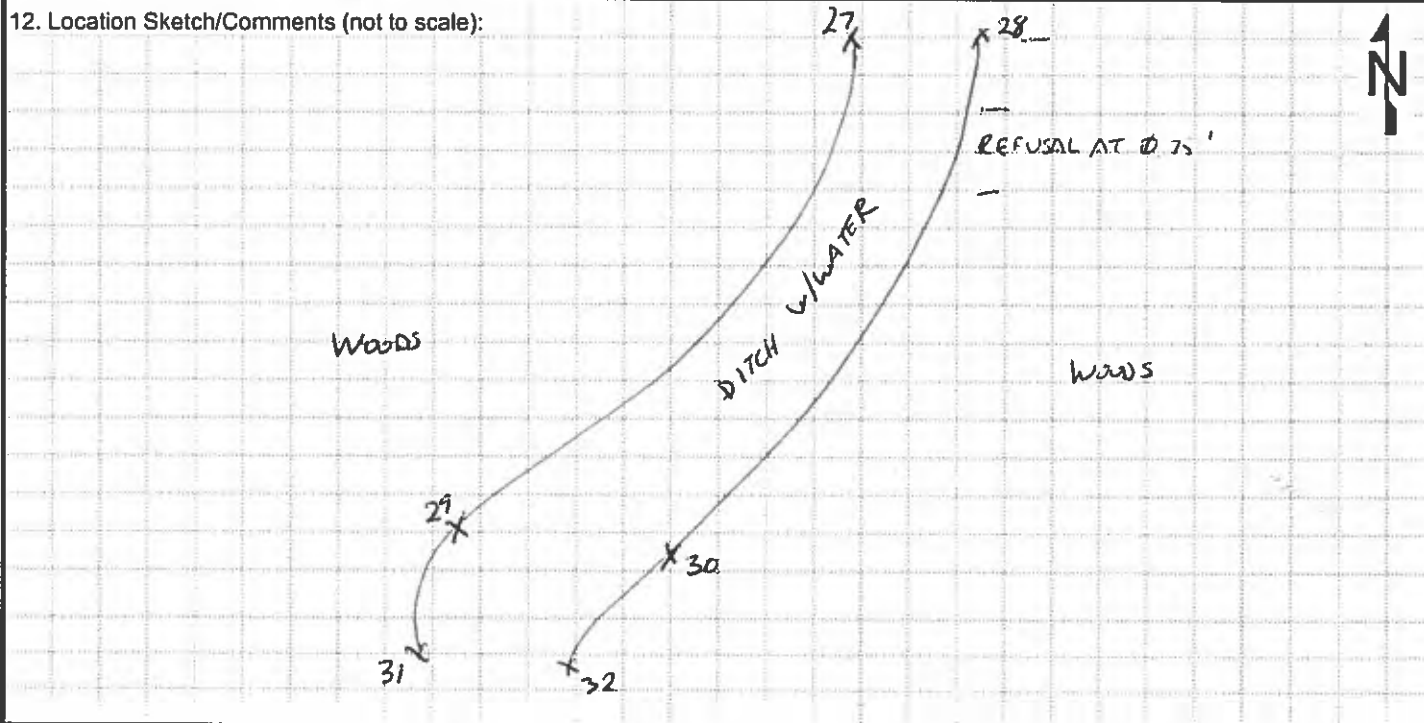

13. MI Soil

Analyses:

- EXPLOSIVES TAL METALS SVOCs PAHs OTHER _____
 FULL SUITE (VOCs, SVOCs, Metals, Explosives, Propellants, Pesticides, PCBs)

Recorded By:

Sara Hide 03/24/14
(Signature and Date)

QC Checked By:

Steve Visocky 3/24/14
(Signature and Date)



RVAAP - Multi-Incremental (MI) Field Form

SHEET 1 OF 1

USACE - Louisville

RVAAP 8451 State Rt. 5
Ravenna, OH 44266

1 Sample Team

Ryan Launch, Mike Denello

2. Location ID:

WSA55-036M

3. Revised Coordinates Recorded:

N/A

4. Sample ID:

WSA55-036M-5647-50

5. Sample Date and Time:

03/24/10 1540

6. Dupe ID:

NA

7. Split ID:

NA

8. MI Equipment Used:

PUSH PROBE, BOWL

9. MS/MSD Collected:

~~YES NA WSA55-036M-NA~~

10. Activities in the Area:

none

11. Soil Description and Field Notes:

SAND, some silt, little clay ^{SM silt}
 SM, SAND, 1. Hic silt, trace clay, trace gravel, fine sand, Angular, light
 olive brown, 2.5 Y 5/3, soft, damp, low plasticity, ^{SM silt} iron
 accumulation, strong brown 7.5 YR 5/8, trace organics (roots)

90% wooded 10% open Area

12. Location Sketch/Comments (not to scale):

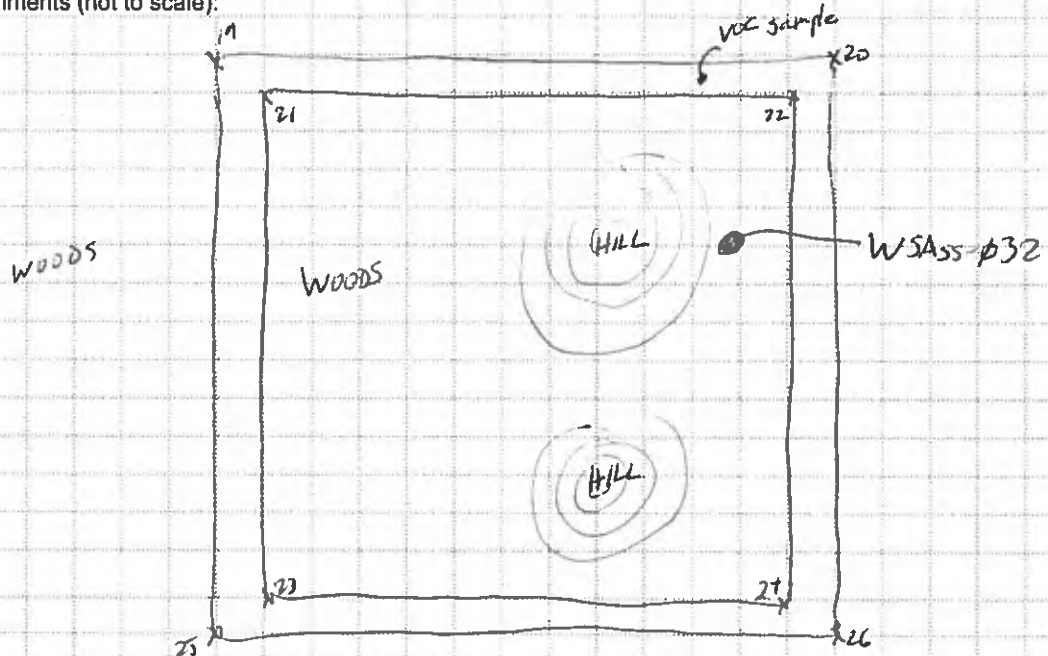

13. MI Soil Analyses:

- EXPLOSIVES TAL METALS SVOCs PAHs OTHER VOCs
 FULL SUITE (VOCs, SVOCs, Metals, Explosives, Propellants, Pesticides, PCBs)

Recorded By:

Sam Nune 03/24/10
 (Signature and Date)

QC Checked By:

Mike Denello 3/24/10
 (Signature and Date)

SOIL BORING SAMPLES

THIS PAGE INTENTIONALLY LEFT BLANK.

HTRW DRILLING LOG		DISTRICT USACE - Louisville	BOREHOLE NUMBER At 3/23/10 LE WSASB-021
1. COMPANY NAME SAIC		2. DRILLING SUBCONTRACTOR Frontz Drilling	
3. PROJECT RVAAP PBA 08 RI		4. LOCATION RVAAP 8451 State Route 5 Ravenna, OH 44266	
5. NAME OF DRILLER JEREMY LEKARONE		6. MAKE/MODEL OF DRILL Geoprobe 6024 DT	
7. SIZES AND TYPES OF SAMPLING EQUIPMENT 3" x 1' HAND AUGER 1.5" x 4' ACETATE LINER 2" x 4' DUAL TUBE		8. BOREHOLE LOCATION 559412.41' N 2357472.23' E	
		9. SURFACE ELEVATION/DATUM 951.79 NAD 83	
		10. DRILL DATE/TIME 03/23/10 STARTED: 1035 COMPLETED: 1140	
		15. DEPTH GROUNDWATER ENCOUNTERED 7.9'	
		16. DEPTH TO WATER/ELAPSED TIME AFTER BOREHOLE COMPLETION NA	
12. OVERBURDEN THICKNESS 13+ FT			
13. DEPTH DRILLED INTO BEDROCK NA		17. OTHER WATER LEVEL MEASUREMENTS (INCLUDE DATE/TIME) NA	
14. TOTAL DEPTH OF BOREHOLE 13 FT			
18. GEOTECHNICAL SAMPLES UNDISTURBED: _____ DISTURBED: _____		19. TOTAL NUMBER OF CORE BOXES NA	
20. CHEMICAL SAMPLES CHEM EXPL/MET/RAI/RAD: NA OTHER: _____		21. TOTAL CORE RECOVERY % NA	
22. DISPOSITION OF BOREHOLE DATE STARTED/INSTALLED: 03/23/10; 1035		DATE COMPLETED/ABANDONED: 03/23/10; 1140	
BACKFILL TYPE: <input type="checkbox"/> GROUT <input checked="" type="checkbox"/> BENTONITE <input type="checkbox"/> TEMPORARY WELL POINT <input type="checkbox"/> MONITORING WELL			
23. NOTES BKG: s Background BGS: Below Ground Surface CPM: Counts per Minute PPM: Parts per Million ▽ : First Water Encountered ▼ : Static Water Level NA: Not Applicable			
LOCATION SKETCH/COMMENTS			SCALE: None
GEOLOGIST SIGNATURE/DATE Amanda Jrenton 03/23/10		QA/QC SIGNATURE/DATE R. Smith 4/26/10	
			BOREHOLE NUMBER WSASB-021



RVAAP-45
Wet Storage Area
WSAsb-021

Drilling Company : Frontz Drilling
 Driller : Jeremy Leckrone
 Designation of Drill : Geoprobe 6620DT
 Type of Drill Rig : Direct Push Technology
 Geologist : Amanda Trenton
 Oversight Company : SAIC
 Borehole Diameter : 2"
 Sampling Equipment : 1.5" x 4' Long Acetate Liner
 : 2" x 4' Dual Tube
 : 3" Hand Auger

RVAAP PBA 2008 Remedial Investigation
 Ravenna Army Ammunition Plant
 8451 State Route 5
 Ravenna, Ohio 44266
 Portage County

Start Date : 03/23/10; 1035
 End Date : 03/23/10; 1140
 Northing Coord. : 559012.41
 Easting Coord. : 2357472.23
 Total Depth of Boring : 13.0'

Depth in feet	USCS Symbol	USCS Graphic	Description	Analyses	Recovery	Collection Interval	Comments
0	ML		(0.0' - 0.3') SILT (ML); little Clay; some Gravel, <3/4"; 10YR3/2 very dark grayish brown; loose; damp; nonplastic; organics throughout.	WSAsb-021-5611-SO collected from 0.0' - 1.0' on 03/23/10 at 1055 for TAL Metals + Hg, PAHs, and Explosives.	1.0'/1.0'		Soil Color Chart Munsell 2000 Rev. Ed.
1	CL		(0.3' - 2.75') CLAY (CL); some Silt; trace Gravel, <1/4"; 2.5Y5/2 gray brown, 5Y6/1 gray, and 10YR5/6 yellowish brown; medium stiff; damp; low plasticity; trace organics.	WSAsb-021-5612-SO collected from 1.0' - 4.0' on 03/23/10 at 1108 for TAL Metals + Hg, PAHs, and Explosives.	2.6'/3.0'		
3	ML		(2.75' - 4.25') SILT (ML); some very fine grained Sand; little Clay; 2.5Y6/6 olive yellow, 2.5Y5/4 light olive brown, and 6/N gray; damp.				
4							
5			(4.25' - 7.9') CLAY (CL); some Silt; 10YR5/4 yellowish brown, 6/N gray, and 2.5Y6/6 olive yellow; stiff; damp; low plasticity.	WSAsb-021-5613-SO, WSAsb-021-6201-FD, & WSAsb-021-6205-QA collected from 4.0' - 7.0' on 03/23/10 at 1120 for TAL Metals + Hg, PAHs, and Explosives.	3.1'/3.0'		
6	CL		(6.5' - 7.9') Siltier.				
7							
8	SM		(7.9' - 9.1') SAND and SILT (SM); 2.5Y5/4 yellowish brown; stiff; damp to moist.		2.85'/3.0'		
9							
10	ML		(9.1' - 10.6') Weathered SHALE and SILT (SH/ML); 2.5Y5/4 yellowish brown; stiff; brittle; damp until 10.1' then dry.	WSAsb-021-5614-SO, WSAsb-021-6202-FD, & WSAsb-021-6206-QA collected from 7.0' - 13.0' on 03/23/10 at 1135 for TAL Metals + Hg, PAHs, and Explosives.			
11			(10.6' - 13.0') Weathered SHALE (SH); 2.5Y5/4 yellowish brown; hard; brittle; dry.				
12	SH		(11.5' - 13.0') Shale is 2.5Y4/1 dark gray.		3.9'/3.0'		
13			Boring terminated at 13.0 ft bgs.				

Coordinate System: NAD 83

Boring backfilled with sodium bentonite chips and hydrated.
 0.0' - 1.0' sampled using a 3" hand auger and triangular subsample procedure for explosives as presented in Section 4.5.2.1.1 of the Facility-wide SAP.
 Samples were composited and homogenized for all analyses.

WSAsb-021

HTRW DRILLING LOG		DISTRICT USACE - Louisville	BOREHOLE NUMBER WSASB-022
1. COMPANY NAME SAIC		2. DRILLING SUBCONTRACTOR Frontz Drilling	
3. PROJECT RVAAP PBA DB RT		4. LOCATION RVAAP 8451 State Route 5 Ravenna, OH 44266	
5. NAME OF DRILLER JEREMY LECKRONE		6. MAKE/MODEL OF DRILL Geoprobe U020 DT	
7. SIZES AND TYPES OF SAMPLING EQUIPMENT 3" x 1" HAND AUGER 1.5" x 4' ACETATE LINER 2" x 4' DUAL TUBE		8. BOREHOLE LOCATION N 559458.0730' E 2357500.8575'	
		9. SURFACE ELEVATION/DATUM NAD 83	
		10. DRILL DATE/TIME 03/23/10 STARTED: 0755 COMPLETED: 1000	
		15. DEPTH GROUNDWATER ENCOUNTERED 7.5'	
12. OVERBURDEN THICKNESS 13+ FT		16. DEPTH TO WATER/ELAPSED TIME AFTER BOREHOLE COMPLETION NA	
13. DEPTH DRILLED INTO BEDROCK NA		17. OTHER WATER LEVEL MEASUREMENTS (INCLUDE DATE/TIME) NA	
14. TOTAL DEPTH OF BOREHOLE 13 FT			
18. GEOTECHNICAL SAMPLES UNDISTURBED: _____ DISTURBED: _____		19. TOTAL NUMBER OF CORE BOXES NA NA	
20. CHEMICAL SAMPLES CHEM: <u>COAL/MET/PAH</u> RAD: NA OTHER: _____		21. TOTAL CORE RECOVERY % NA	
22. DISPOSITION OF BOREHOLE DATE STARTED/INSTALLED: 03/23/10; 0755		DATE COMPLETED/ABANDONED: 03/23/10; 1000	
BACKFILL TYPE: <input type="checkbox"/> GROUT <input checked="" type="checkbox"/> BENTONITE <input type="checkbox"/> TEMPORARY WELL POINT <input type="checkbox"/> MONITORING WELL			
23. NOTES BKG: \leq Background BGS: Below Ground Surface CPM: Counts per Minute PPM: Parts per Million ∇ : First Water Encountered \blacktriangledown : Static Water Level NA: Not Applicable			

LOCATION SKETCH/COMMENTS	SCALE: None
---------------------------------	--------------------

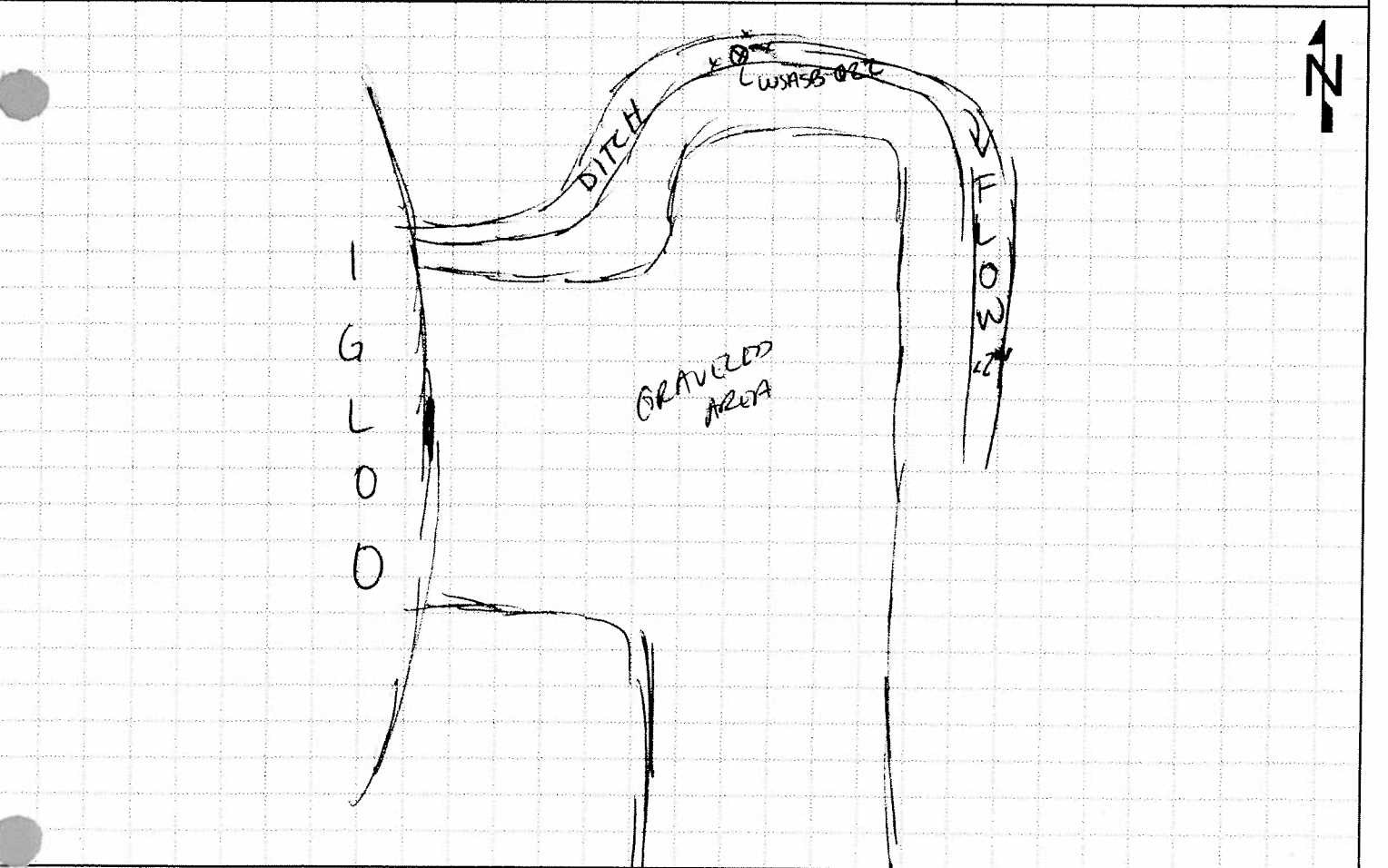

GEOLOGIST SIGNATURE/DATE Amanda Trenton 03/23/10	QA/QC SIGNATURE/DATE RS 4/26/10	BOREHOLE NUMBER WSASB-022
---	------------------------------------	------------------------------



RVAAP-45
Wet Storage Area
WSAsb-022

Drilling Company : Frontz Drilling
 Driller : Jeremy Leckrone
 Designation of Drill : Geoprobe 6620DT
 Type of Drill Rig : Direct Push Technology
 Geologist : Amanda Trenton
 Oversight Company : SAIC
 Borehole Diameter : 2"
 Sampling Equipment : 1.5" x 4' Long Acetate Liner
 : 2" x 4' Dual Tube
 : 3" Hand Auger

RVAAP PBA 2008 Remedial Investigation
 Ravenna Army Ammunition Plant
 8451 State Route 5
 Ravenna, Ohio 44266
 Portage County

Start Date : 03/23/10; 0755
 End Date : 03/23/10; 1000
 Northing Coord. : 559458.0730
 Easting Coord. : 2357500.8575
 Total Depth of Boring : 13.0'

Depth in feet	USCS Symbol	USCS Graphic	Description	Analyses	Recovery	Collection Interval	Comments
0	ML	[ML Graphic]	(0.0' - 0.3') SILT (ML); little Clay; some Gravel, <3/4", angular; 10YR3/2 very dark grayish brown; loose; wet from water in ditch; nonplastic.	WSAsb-022-5615-SO collected from 0.0' - 1.0' on 03/23/10 at 0850 for VOCs, SVOCs, PCBs, Pesticides, Explosives, Propellants, and TAL Metals + Hg.	1.0'/1.0'		Soil Color Chart Munsell 2000 Rev. Ed.
1	CL	[CL Graphic]	(0.3' - 0.8') CLAY (CL); little Silt; trace Gravel, <1/2", subangular; trace Sand lenses; 2.5Y5/3 brown, trace 7.5YR6/6 reddish yellow, and 5Y5/2 olive gray; medium stiff; damp; medium plasticity.		A 2.9'/3.0'		Sample interval was wet due to surface water in ditch. Soil was dry. VOCs were collected from first core.
2	CL	[CL Graphic]	(0.8' - 4.7') CLAY (CL); little Silt; trace Gravel, <1/4"; 2.5Y6/4 light yellowish brown, little 10YR5/6 yellowish brown, and 2.5Y5/1 gray; medium stiff, stiff by 2.0'; dry; medium plasticity.	WSAsb-022-5616-SO, WSAsb-022-6200-FD, & WSAsb-022-6204-QA collected from 1.0' - 4.0' on 03/23/10 at 0915 for VOCs, SVOCs, PCBs, Pesticides, Explosives, Propellants, and TAL Metals + Hg.	B 3.0'/4.0'		
3	CL	[CL Graphic]			C 3.9'/4.0'		
5	GC	[GC Graphic]	(4.7' - 5.7') CLAY and GRAVEL (GC); Gravel is <1" and subangular; some Sand; 10YR5/4 yellowish brown; loose; wet.	WSAsb-022-5617-SO collected from 4.0' - 7.0' on 03/23/10 at 0935 for VOCs, SVOCs, PCBs, Pesticides, Explosives, Propellants, and TAL Metals + Hg.	3.0'/3.0'		
6	CL	[CL Graphic]	(5.7' - 7.5') CLAY (CL); little Silt; trace Gravel, <1/2"; 10YR5/4 yellowish brown and 2.5Y6/1 gray; stiff; dry; medium plasticity.				
7	CL	[CL Graphic]	(6.9' - 7.5') Siltier.				
8	GM	[GM Graphic]	(7.5' - 7.8') Subangular GRAVEL (GM); silt matrix; 10YR5/4 yellowish brown; wet.				
9	SH	[SH Graphic]	(7.8' - 13.0') Weathered SHALE (SH); 10YR7/3 very pale brown, little 10YR5/6 yellowish brown; brittle; crumbly; dry.		4.0'/3.0'		
10	SH	[SH Graphic]	(9.9' - 10.5') Shale is black with some 10YR5/6 yellowish brown.	WSAsb-022-5618-SO collected from 7.0' - 13.0' on 03/23/10 at 0955 for VOCs, SVOCs, PCBs, Pesticides, Explosives, Propellants, and TAL Metals + Hg.			
11	SH	[SH Graphic]			4.0'/3.0'		
12	SH	[SH Graphic]	(12.0' - 13.0') Hard.				
13			Boring terminated at 13.0 ft bgs.				Coordinate System: NAD 83

Boring backfilled with sodium bentonite chips and hydrated.
 0.0' - 1.0' sampled using a 3" hand auger and triangular subsample procedure for explosives as presented in Section 4.5.2.1.1 of the Facility-wide SAP. Samples were composited and homogenized for all analyses except VOCs. Twin boreholes were drilled to obtain volume required for analyses.

WSAsb-022



RVAAP-45
Wet Storage Area
WSAsb-023

Drilling Company : Frontz Drilling
 Driller : Jeremy Leckrone
 Designation of Drill : Geoprobe 6620DT
 Type of Drill Rig : Direct Push Technology
 Geologist : Amanda Trenton
 Oversight Company : SAIC
 Borehole Diameter : 2"
 Sampling Equipment : 1.5" x 4' Long Acetate Liner
 : 2" x 4' Dual Tube
 : 3" Hand Auger

RVAAP PBA 2008 Remedial Investigation
 Ravenna Army Ammunition Plant
 8451 State Route 5
 Ravenna, Ohio 44266
 Portage County

Start Date : 03/23/10; 1605
 End Date : 03/23/10; 1650
 Northing Coord. : 559473.00
 Easting Coord. : 2357031.00
 Total Depth of Boring : 13.0'

Depth in feet	USCS Symbol	USCS Graphic	Description	Analyses	Recovery	Collection Interval	Comments
0	ML		(0.0' - 0.25') SILT (ML); some Clay; 10YR4/2 dark grayish brown; loose; damp; organics throughout.	WSAsb-023-5619-SO collected from 0.0' - 1.0' on 03/23/10 at 1622 for TAL Metals + Hg, PAHs, and Explosives.	1.0'/1.0'		Soil Color Chart Munsell 2000 Rev. Ed.
1	CL		(0.25' - 1.65') CLAY (CL); little Silt; 10YR4/3 brown, 10YR5/6 yellowish brown, and N7/ light gray; medium stiff; damp to dry.				
2	SW		(1.65' - 2.1') SAND (SW); little fines; 2.5Y5/4 light olive brown; loose; wet; nonplastic.	WSAsb-023-5620-SO collected from 1.0' - 4.0' on 03/23/10 at 1630 for TAL Metals + Hg, PAHs, and Explosives.	2.65'/3.0'		
3	ML		(2.1' - 2.6') SILT (ML); some fine grained Sand; trace Clay; 2.5Y5/4 light olive brown; stiff; damp.				
4	SM		(2.6' - 6.7') Fine grained SAND and SILT (SM); 2.5Y5/4 light olive brown; medium dense; damp. (3.5' - 4.0') Softer. (4.0' - 5.0') Moist.				
5				WSAsb-023-5621-SO collected from 4.0' - 7.0' on 03/23/10 at 1637 for TAL Metals + Hg, PAHs, and Explosives.	2.75'/3.0'		
6							
7			(6.7' - 10.7') Very fine to fine grained SAND (SW); little Silt; 2.5Y5/4 light olive brown; dense; damp, moist in pockets; nonplastic.	WSAsb-023-5622-SO collected from 7.0' - 13.0' on 03/23/10 at 1650 for TAL Metals + Hg, PAHs, and Explosives.	3.35'/3.0'		
8							
9	SW		(9.2' - 10.7') Very dense.				
10			(10.0' - 10.7') Medium grained SAND; moist.	3.0'/3.0'			
11			(10.7' - 13.0') SILT (ML); little Sand; trace Gravel; 10YR5/4 yellowish brown; stiff; dry.				
12	ML						
13			Boring terminated at 13.0 ft bgs.				Coordinate System: NAD 83

Boring backfilled with sodium bentonite chips and hydrated.
 0.0' - 1.0' sampled using a 3" hand auger and triangular subsample procedure for explosives as presented in Section 4.5.2.1.1 of the Facility-wide SAP.
 Samples were composited and homogenized for all analyses.

WSAsb-023

HTRW DRILLING LOG		DISTRICT USACE - Louisville	BOREHOLE NUMBER WSA SB-024
1. COMPANY NAME SAIC		2. DRILLING SUBCONTRACTOR Frontz Drilling	
3. PROJECT BVAAP - PBAOB RI		4. LOCATION RVAAP 8451 State Route 5 Ravenna, OH 44266	
5. NAME OF DRILLER Jeremy LeRone (Ethan) Frontz - helper		6. MAKE/MODEL OF DRILL Geoprobe 10620 DT	
7. SIZES AND TYPES OF SAMPLING EQUIPMENT 3" x 1' HAND RUBBER 1.5" x 4' ACETATE LINER 2" x 4' DUAL TUBE		8. BOREHOLE LOCATION N-5592015794' E-235700258'	
		9. SURFACE ELEVATION/DATUM NA 83	
		10. DRILL DATE/TIME STARTED: 3/24/10 0920 COMPLETED: 3/24/10 1105	
		15. DEPTH GROUNDWATER ENCOUNTERED NA	
		16. DEPTH TO WATER/ELAPSED TIME AFTER BOREHOLE COMPLETION NA	
12. OVERBURDEN THICKNESS 13 + FT		17. OTHER WATER LEVEL MEASUREMENTS (INCLUDE DATE/TIME) NA	
13. DEPTH DRILLED INTO BEDROCK NA			
14. TOTAL DEPTH OF BOREHOLE 13 FT			
18. GEOTECHNICAL SAMPLES UNDISTURBED: _____ DISTURBED: _____		19. TOTAL NUMBER OF CORE BOXES NA	
20. CHEMICAL SAMPLES CHEM: MET/PAH/DIA RAD: NA OTHER: _____		21. TOTAL CORE RECOVERY % NA	
22. DISPOSITION OF BOREHOLE DATE STARTED/INSTALLED: 03/24/10; 0920		DATE COMPLETED/ABANDONED: 03/24/10; 1105	
BACKFILL TYPE: <input type="checkbox"/> GROUT <input checked="" type="checkbox"/> BENTONITE <input type="checkbox"/> TEMPORARY WELL POINT <input type="checkbox"/> MONITORING WELL			
23. NOTES BKG: ≤ Background BGS: Below Ground Surface CPM: Counts per Minute PPM: Parts per Million ▽ : First Water Encountered ▼ : Static Water Level NA: Not Applicable			

LOCATION SKETCH/COMMENTS SCALE: None

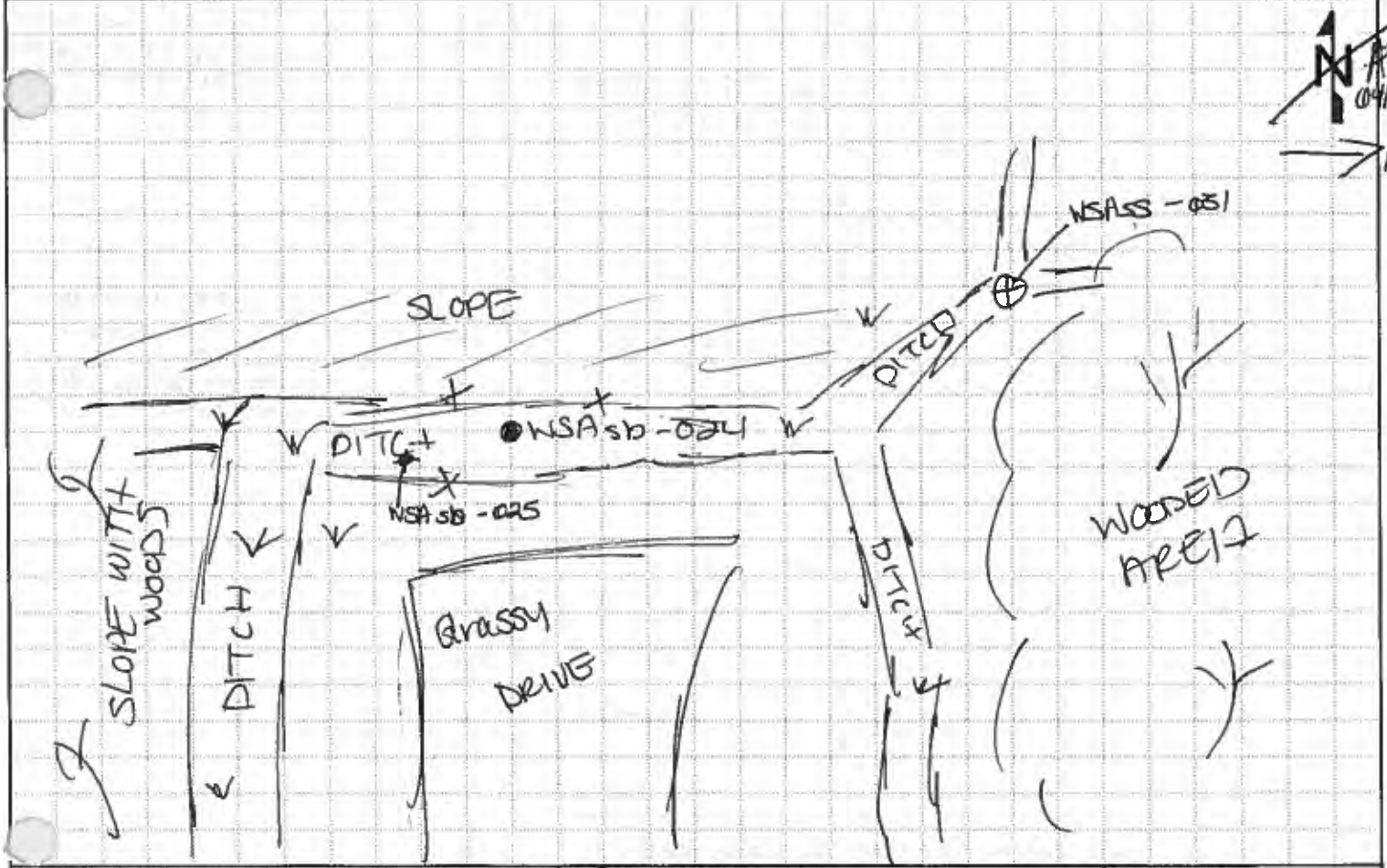

GEOLOGIST SIGNATURE/DATE Emily Cunningham 03/24/10	QA/QC SIGNATURE/DATE Amanda Henton 04/02/10	BOREHOLE NUMBER WSA SB-024
---	--	-------------------------------



RVAAP-45
Wet Storage Area
WSAsb-024

Drilling Company : Frontz Drilling
 Driller : Jeremy Leckrone
 Designation of Drill : Geoprobe 6620DT
 Type of Drill Rig : Direct Push Technology
 Geologist : Emily Cunningham
 Oversight Company : SAIC
 Borehole Diameter : 2"
 Sampling Equipment : 1.5" x 4' Long Acetate Liner
 : 2" x 4' Dual Tube
 : 3" Hand Auger

RVAAP PBA 2008 Remedial Investigation
 Ravenna Army Ammunition Plant
 8451 State Route 5
 Ravenna, Ohio 44266
 Portage County

Start Date : 03/24/10; 0920
 End Date : 03/24/10; 1120
 Northing Coord. : 559261.5794
 Easting Coord. : 2357002.258
 Total Depth of Boring : 13.0'

Depth in feet	USCS Symbol	USCS Graphic	Description	Analyses	Recovery	Collection Interval	Comments
0	ML		(0.0' - 1.0') Clayey SILT (ML); little 1/2" Gravel; trace Sand; 10YR5/8 yellowish brown and 10YR6/1 gray; moist; slight plasticity; trace organics (roots).	WSAsb-024-5623-SO collected from 0.0' - 1.0' on 03/23/10 at 0920 for TAL Metals + Hg, PAHs, and Explosives.	1.0'/1.0'		Soil Color Chart Munsell 2000 Rev. Ed.
1	ML		(1.0' - 2.2') SILT (ML); some Clay; 10YR4/6 dark yellowish brown and 10YR6/1 gray; moist; slight plasticity.				
2			(2.2' - 5.1') Sandy SILT (ML); trace fine Gravel; 2.5Y5/4 light olive brown; damp; nonplastic.	WSAsb-024-5624-SO, WSAsb-024-6207-QA, & WSAsb-024-6208-FD collected from 1.0' - 4.0' on 03/24/10 at 1025 for TAL Metals + Hg, PAHs, and Explosives.	A 2.4'/3.0' B 3.2'/4.0'		
3	ML						
4			(5.1' - 7.0') Silty SAND (SM); 2.5Y5/4 light olive brown; stiff; moist to wet; nonplastic.	WSAsb-024-5625-SO collected from 4.0' - 7.0' on 03/24/10 at 1043 for TAL Metals + Hg, PAHs, and Explosives.	2.9'/3.0'		
5	SM						
6			(6.5' - 7.0') Hard; dry.	WSAsb-024-5626-SO collected from 7.0' - 13.0' on 03/24/10 at 1105 for TAL Metals + Hg, PAHs, and Explosives.	3.4'/3.0'		
7	SM						
8			(7.0' - 12.5') Silty SAND (SM); 1/2" Gravel; 2.5Y5/6 light olive brown; medium dense; dry; nonplastic.	WSAsb-024-5626-SO collected from 7.0' - 13.0' on 03/24/10 at 1105 for TAL Metals + Hg, PAHs, and Explosives.	3.4'/3.0'		
9	SM						
10			(11.5' - 12.5') Less dense, crumbles easily.	WSAsb-024-5626-SO collected from 7.0' - 13.0' on 03/24/10 at 1105 for TAL Metals + Hg, PAHs, and Explosives.	3.8'/3.0'		
11	SM						
12			(12.5' - 13.0') Fine to medium grained SAND (SM); little Silt; 10YR5/8 yellowish brown; loose; moist; nonplastic.	WSAsb-024-5626-SO collected from 7.0' - 13.0' on 03/24/10 at 1105 for TAL Metals + Hg, PAHs, and Explosives.	3.8'/3.0'		
13	SM						
			Boring terminated at 13.0 ft bgs.				Coordinate System: NAD 83

Boring backfilled with sodium bentonite chips and hydrated.
 0.0' - 1.0' sampled using a 3" hand auger and triangular subsample procedure for explosives as presented in Section 4.5.2.1.1 of the Facility-wide SAP.
 Samples were composited and homogenized for all analyses.
 Twin boreholes were drilled to obtain volume required for analyses.

WSAsb-024

HTRW DRILLING LOG		DISTRICT	BOREHOLE NUMBER
1. COMPANY NAME SAIC		USACE - Louisville	WSASb-025 <i>shadi</i>
2. DRILLING SUBCONTRACTOR Frontz Drilling		SHEET 1 OF 24	
3. PROJECT RVAAP PBA 08 RF		4. LOCATION RVAAP 8451 State Route 5 Ravenna, OH 44266	
5. NAME OF DRILLER Jeremy Leckrone		6. MAKE/MODEL OF DRILL Geoprobe V620DT	
7. SIZES AND TYPES OF SAMPLING EQUIPMENT 1.5" x 4' ACEDATE LINER 2' x 4' DUAL TUBE 4 1/4" x 5' Hollow Stem Augers		8. BOREHOLE LOCATION N-559243.5018' E-2355003.32'	
12. OVERBURDEN THICKNESS 23.8 FT		9. SURFACE ELEVATION/DATUM NAD 83	
13. DEPTH DRILLED INTO BEDROCK NA		10. DRILL DATE/TIME 03/24/10	
14. TOTAL DEPTH OF BOREHOLE 28 FT		11. STARTED: 0830 COMPLETED: 1105	
18. GEOTECHNICAL SAMPLES UNDISTURBED: TWO DISTURBED: _____		15. DEPTH GROUNDWATER ENCOUNTERED	
19. TOTAL NUMBER OF CORE BOXES NA		16. DEPTH TO WATER/ELAPSED TIME AFTER BOREHOLE COMPLETION NA	
20. CHEMICAL SAMPLES CHEM at 2100 RAD: NA OTHER: _____		17. OTHER WATER LEVEL MEASUREMENTS (INCLUDE DATE/TIME) NA	
21. TOTAL CORE RECOVERY % NA		22. DISPOSITION OF BOREHOLE DATE STARTED/INSTALLED: 03/24/10 DATE COMPLETED/ABANDONED: 03/24/10	
BACKFILL TYPE: <input type="checkbox"/> GROUT <input checked="" type="checkbox"/> BENTONITE <input type="checkbox"/> TEMPORARY WELL POINT <input type="checkbox"/> MONITORING WELL			
23. NOTES BKG: s Background BGS: Below Ground Surface CPM: Counts per Minute PPM: Parts per Million ▽ : First Water Encountered ▼ : Static Water Level NA: Not Applicable			
LOCATION SKETCH/COMMENTS			SCALE: None
GEOLOGIST SIGNATURE/DATE Amanda Trenton 03/24/10		QA/QC SIGNATURE/DATE RSM 04/26/10	
		BOREHOLE NUMBER WSASB-025	



RVAAP-45
Wet Storage Area
WSAsb-025

Drilling Company : Frontz Drilling
 Driller : Jeremy Leckrone
 Designation of Drill : Geoprobe 6620DT
 Type of Drill Rig : Direct Push Technology
 Geologist : Amanda Trenton
 Oversight Company : SAIC
 Borehole Diameter : 8"
 Sampling Equipment : 4.25" Hollow Stem Augers
 : 28" x 3" Shelby Tube

RVAAP PBA 2008 Remedial Investigation
 Ravenna Army Ammunition Plant
 8451 State Route 5
 Ravenna, Ohio 44266
 Portage County

Start Date : 03/24/10; 0830
 End Date : 03/24/10; 1105
 Northing Coord. : 559243.5618
 Easting Coord. : 2355003.32
 Total Depth of Boring : 28.0 ft

Depth in feet	USCS Symbol	USCS Graphic	Description	Analyses	Recovery	Collection Interval	Comments
0			(0.0' - 1.5') Medium grained SAND (SM); little Silt; little sandstone Gravel; 10YR5/6 yellowish brown, 10YR5/3 brown, and 5YR6/6 reddish yellow; medium dense; dry; nonplastic; trace slag, coal, and brick fill; sand and sandstone is micaceous.				Soil Color Chart Munsell 2000 Rev. Ed.
1	SM		(1.5' - 6.6') SILT (ML); some fine grained Sand; trace Clay; trace Gravel, <1/2", subangular; 2.5Y5/4 yellowish brown; medium stiff; dry.		3.25'/4.0'		
2				Shelby Tube WSAsb-025-5627-SO collected from 4.0' - 5.2' on 03/24/10 at 1036 for Porosity, Bulk Density, Moisture Content, Total Organic Carbon, Permeability, and Grain Size Fraction Analysis.			
3							
4	ML		(6.0' - 6.6') Sand content increases with depth.		4.0'/4.0'		
5							
6							
7			(6.6' - 8.8') Fine and very fine grained SAND (SM); little Silt; 10YR5/4 yellowish brown; dense; moist.	Shelby Tube WSAsb-025-5628-SO collected from 12.0' - 13.1' (Shelby refusal) on 03/24/10 at 1042 for Porosity, Bulk Density, Moisture Content, Total Organic Carbon, Permeability, and Grain Size Fraction Analysis.			Coordinate System: NAD 83
8	SM		(8.8' - 14.1') Fine and very fine grained SAND (SW); trace Silt; 10YR5/4 yellowish brown and 10YR5/6 yellowish brown; dense; dry to damp in pockets.		4.0'/4.0'		
9			(10.0' - 10.8') Siltier; little <1/4" Gravel.				
10			(10.8' - 14.1') Coarser grained Sand and Gravel (<1" subangular).				
11							
12	SW		(12.5' - 14.1') Hard.	4.0'/4.0'			
13							
14							
15	SW		(14.1' - 15.8') Fine and very fine grained SAND (SW); 10YR5/3 brown & 10YR5/6 yellowish brown; dense; moist.				

Boring backfilled with sodium bentonite chips and hydrated.
 Shelby tubes sealed with wax and capped.

WSAsb-025



RVAAP-45
Wet Storage Area
WSAsb-025

Drilling Company : Frontz Drilling
 Driller : Jeremy Leckrone
 Designation of Drill : Geoprobe 6620DT
 Type of Drill Rig : Direct Push Technology
 Geologist : Amanda Trenton
 Oversight Company : SAIC
 Borehole Diameter : 8"
 Sampling Equipment : 4.25" Hollow Stem Augers
 : 28" x 3" Shelby Tube

RVAAP PBA 2008 Remedial Investigation
 Ravenna Army Ammunition Plant
 8451 State Route 5
 Ravenna, Ohio 44266
 Portage County

Start Date : 03/24/10; 0830
 End Date : 03/24/10; 1105
 Northing Coord. : 559243.5618
 Easting Coord. : 2355003.32
 Total Depth of Boring : 28.0 ft

Depth in feet	USCS Symbol	USCS Graphic	Description	Analyses	Recovery	Collection Interval	Comments
15	SW		Soil description located on page 1.				Soil Color Chart Munsell 2000 Rev. Ed.
16			(15.8' - 19.5') Very fine grained SAND (SM); some Silt; some coarser grained Sand and Gravel, < 1", subangular; 10YR5/3 brown, little 10YR5/6 yellowish brown; hard; dry. Silt content increases with depth.		4.0'/4.0'		
17	SM						
18			(19.5' - 20.9') SILT (ML); some Sand; little Gravel, <1.25", subangular; 2.5Y4/2 dark grayish brown, little 10YR5/6 yellowish brown.		4.0'/4.0'		
19	ML						
20							
21	SS		(20.9' - 21.2') SANDSTONE; weathered; micaceous.		4.0'/4.0'		
22	SW		(21.2' -22.0') Medium grained SAND (SW); some Sandstone fragments.				
23	ML		(22.0' - 23.3') SILT (ML); little Sand; little Gravel, 1/4" - 3/4", subangular; N4/ dark gray with some 10YR5/3 brown; hard; dry; low plasticity.				
24	SH		(23.3' - 23.8') Weathered SHALE and SILT (SH); 2.5Y6/1 gray; hard; dry.				
25			(23.8' - 28.0') Weathered SHALE (SH); 2.5Y6/1 gray; brittle; crumbly; dry.		4.0'/4.0'		
26	SH						
27							
28			Boring terminated at 28 ft bgs. Offset and auger for Shelby tube collection.				
29							
30							

Coordinate System: NAD 83

Boring backfilled with sodium bentonite chips and hydrated.
 Shelby tubes sealed with wax and capped.

WSAsb-025

HTRW DRILLING LOG		DISTRICT USACE - Louisville	BOREHOLE NUMBER WSASD-026
1. COMPANY NAME SAIC		2. DRILLING SUBCONTRACTOR Frontz Drilling	
3. PROJECT RVAAP PBA 08 RI		4. LOCATION RVAAP 8451 State Route 5 Ravenna, OH 44266	
5. NAME OF DRILLER Jeremy Letkrome		6. MAKE/MODEL OF DRILL Geoprobe 6024DT	
7. SIZES AND TYPES OF SAMPLING EQUIPMENT 3" x 1' HAND AUGER 1.5" x 4' ACETATE LINER 2" x 4' DUAL TUBE		8. BOREHOLE LOCATION N. 559131.69' E 235707.47'	
		9. SURFACE ELEVATION/DATUM NA 83	
		10. DRILL DATE/TIME 03/23/10 STARTED: 1340 COMPLETED: 1440	
		15. DEPTH GROUNDWATER ENCOUNTERED NA	
12. OVERBURDEN THICKNESS > 13 FT		16. DEPTH TO WATER/ELAPSED TIME AFTER BOREHOLE COMPLETION NA	
13. DEPTH DRILLED INTO BEDROCK NA		17. OTHER WATER LEVEL MEASUREMENTS (INCLUE DATE/TIME) NA	
14. TOTAL DEPTH OF BOREHOLE 13 FT			
18. GEOTECHNICAL SAMPLES UNDISTURBED: _____ DISTURBED: _____		19. TOTAL NUMBER OF CORE BOXES NA	
20. CHEMICAL SAMPLES CHEM: <u>AC/PAH/CXA</u> RAD: NA OTHER: _____		21. TOTAL CORE RECOVERY % NA	
22. DISPOSITION OF BOREHOLE DATE STARTED/INSTALLED: 03/23/10; 1340		DATE COMPLETED/ABANDONED: 03/23/10; 1440	
BACKFILL TYPE: <input type="checkbox"/> GROUT <input checked="" type="checkbox"/> BENTONITE <input type="checkbox"/> TEMPORARY WELL POINT <input type="checkbox"/> MONITORING WELL			
23. NOTES BKG: \triangleleft Background BGS: Below Ground Surface CPM: Counts per Minute PPM: Parts per Million ∇ : First Water Encountered \blacktriangledown : Static Water Level NA: Not Applicable			

LOCATION SKETCH/COMMENTS	SCALE: None
---------------------------------	--------------------

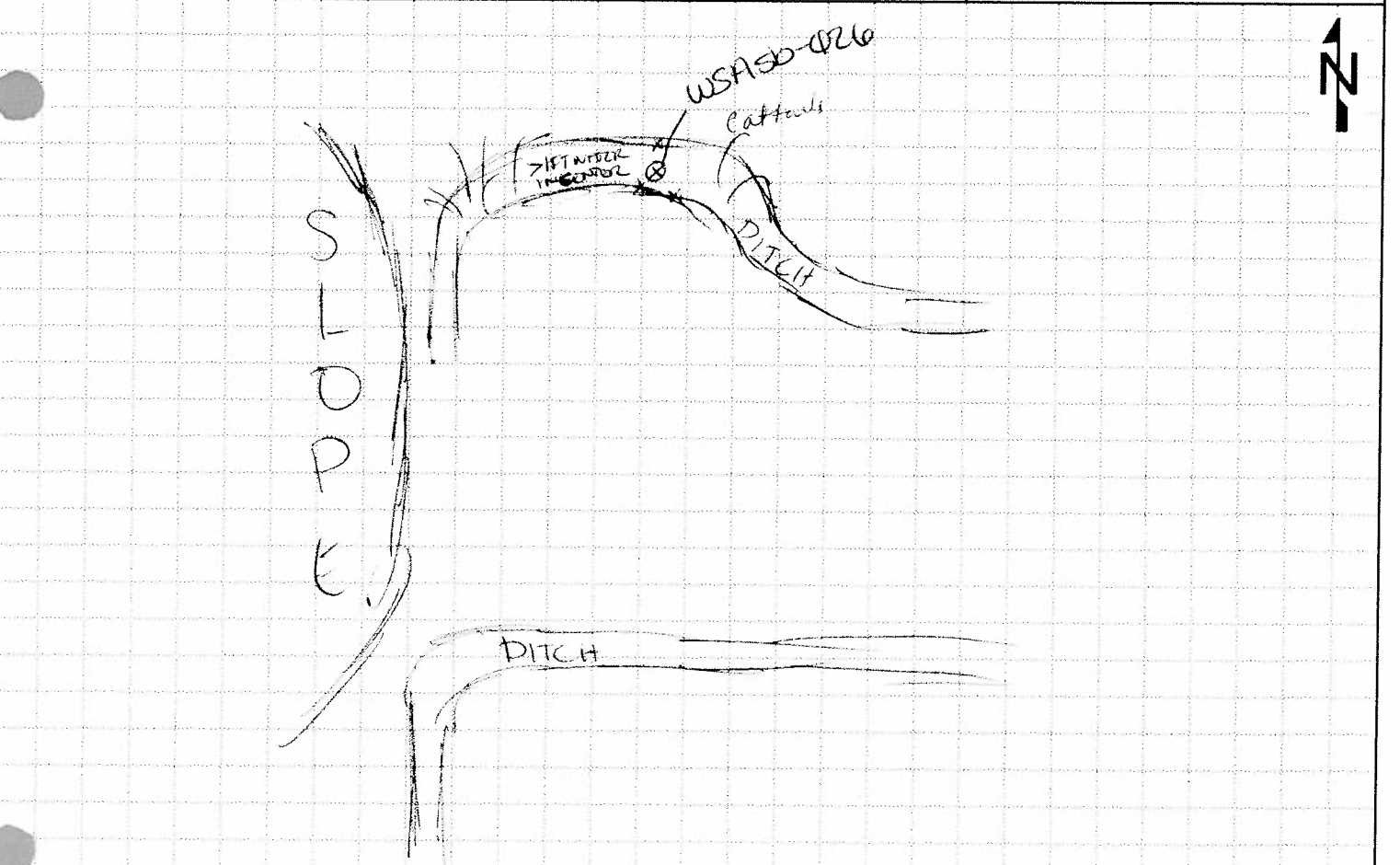

GEOLOGIST SIGNATURE/DATE Amanda Jenton 03/23/10	QA/QC SIGNATURE/DATE R. J. 4/26/10	BOREHOLE NUMBER WSASD-026
--	---------------------------------------	------------------------------



RVAAP-45
Wet Storage Area
WSAsb-026

Drilling Company : Frontz Drilling
 Driller : Jeremy Leckrone
 Designation of Drill : Geoprobe 6620DT
 Type of Drill Rig : Direct Push Technology
 Geologist : Amanda Trenton
 Oversight Company : SAIC
 Borehole Diameter : 2"
 Sampling Equipment : 1.5" x 4' Long Acetate Liner
 : 2" x 4' Dual Tube
 : 3" Hand Auger

RVAAP PBA 2008 Remedial Investigation
 Ravenna Army Ammunition Plant
 8451 State Route 5
 Ravenna, Ohio 44266
 Portage County

Start Date : 03/23/10; 1340
 End Date : 03/23/10; 1440
 Northing Coord. : 559131.69
 Easting Coord. : 2357047.47
 Total Depth of Boring : 13.0'

Depth in feet	USCS Symbol	USCS Graphic	Description	Analyses	Recovery	Collection Interval	Comments
0	ML		(0.0' - 0.8') SILT (ML); some Clay; 10YR4/2 dark grayish brown; very soft, wet from surface water in ditch; organics throughout.	WSAsb-026-5629-SO collected from 0.0' - 1.0' on 03/23/10 at 1400 for TAL Metals + Hg, PAHs, and Explosives.			Soil Color Chart Munsell 2000 Rev. Ed.
1			(0.8' - 13.0') SILT (ML); some Clay; 10YR5/3 brown, 10YR5/6 yellowish brown, and 10Y6/1 greenish gray; medium dense; damp; exterior slightly wet from surface runoff.	WSAsb-026-5630-SO collected from 1.0' - 4.0' on 03/23/10 at 1407 for TAL Metals + Hg, PAHs, and Explosives.	2.8'/4.0'		
2							
3							
4			(4.0' - 13.0') SILT is 5Y5/3 olive and 10YR5/6 yellowish brown; dry.				
5			(5.0' - 13.0') Introduction of trace Clay and trace Gravel, <1/2", subangular.	WSAsb-026-5631-SO and MS/MSD collected from 4.0' - 7.0' on 03/23/10 at 1420 for TAL Metals + Hg, PAHs, and Explosives.	3.2'/3.0'		
6							
7	ML		(7.5' - 13.0') Very stiff.				
8							
9							
10				WSAsb-026-5632-SO collected from 7.0' - 13.0' on 03/23/10 at 1440 for TAL Metals + Hg, PAHs, and Explosives.	3.5'/3.0'		
11							
12			(11.5' - 13.0') Damp.				
13			Boring terminated at 13.0 ft bgs.		4.0'/3.0'		

Coordinate System: NAD 83

Boring backfilled with sodium bentonite chips and hydrated.
 0.0' - 1.0' sampled using a 3" hand auger and triangular subsample procedure for explosives as presented in Section 4.5.2.1.1 of the Facility-wide SAP.
 Samples were composited and homogenized for all analyses.

WSAsb-026

HTRW DRILLING LOG		DISTRICT	BOREHOLE NUMBER
1. COMPANY NAME SAIC		USACE - Louisville	WSASB-027
3. PROJECT RVAAP PBA 08 RI		2. DRILLING SUBCONTRACTOR Frontz Drilling	SHEET 1 OF 2
5. NAME OF DRILLER JEREMY LEKRONE		4. LOCATION RVAAP 8451 State Route 5 Ravenna, OH 44266	
7. SIZES AND TYPES OF SAMPLING EQUIPMENT 3" x 1 1/2" HAND AUGER 1.5" x 4' ACETATE LINER 2" x 4' DUAL TUBE		6. MAKE/MODEL OF DRILL Geoprobe 10620 DT	
12. OVERBURDEN THICKNESS 713 FT		8. BOREHOLE LOCATION N 559044.54' E 2357011.73'	
13. DEPTH DRILLED INTO BEDROCK NA		9. SURFACE ELEVATION/DATUM 947.25' NAD 83	
14. TOTAL DEPTH OF BOREHOLE 13 FT		10. DRILL DATE/TIME STARTED: 1445 COMPLETED: 1550	
18. GEOTECHNICAL SAMPLES UNDISTURBED: _____ DISTURBED: _____		15. DEPTH GROUNDWATER ENCOUNTERED 7.5 FT	
20. CHEMICAL SAMPLES CHEM: <u>NO/PA/UA</u> RAD: NA OTHER: _____		16. DEPTH TO WATER/ELAPSED TIME AFTER BOREHOLE COMPLETION NA	
22. DISPOSITION OF BOREHOLE DATE STARTED/INSTALLED: 03/23/10; 1445 DATE COMPLETED/ABANDONED: 03/23/10; 1550		17. OTHER WATER LEVEL MEASUREMENTS (INCLUDE DATE/TIME) NA	
BACKFILL TYPE: <input type="checkbox"/> GROUT <input checked="" type="checkbox"/> BENTONITE <input type="checkbox"/> TEMPORARY WELL POINT <input type="checkbox"/> MONITORING WELL		19. TOTAL NUMBER OF CORE BOXES NA	
23. NOTES BKG: s Background BGS: Below Ground Surface CPM: Counts per Minute PPM: Parts per Million ▽ : First Water Encountered ▼ : Static Water Level NA: Not Applicable		21. TOTAL CORE RECOVERY % NA	
LOCATION SKETCH/COMMENTS			SCALE: None
GEOLOGIST SIGNATURE/DATE Amanda Henton 03/23/10		QA/QC SIGNATURE/DATE RS 04/26/10	BOREHOLE NUMBER WSASB-027



RVAAP-45
Wet Storage Area
WSAsb-027

Drilling Company : Frontz Drilling
 Driller : Jeremy Leckrone
 Designation of Drill : Geoprobe 6620DT
 Type of Drill Rig : Direct Push Technology
 Geologist : Amanda Trenton
 Oversight Company : SAIC
 Borehole Diameter : 2"
 Sampling Equipment : 1.5" x 4' Long Acetate Liner
 : 2" x 4' Dual Tube
 : 3" Hand Auger

RVAAP PBA 2008 Remedial Investigation
 Ravenna Army Ammunition Plant
 8451 State Route 5
 Ravenna, Ohio 44266
 Portage County

Start Date : 03/23/10; 1445
 End Date : 03/23/10; 1550
 Northing Coord. : 559043.221
 Easting Coord. : 2357007.016
 Total Depth of Boring : 13.0'

Depth in feet	USCS Symbol	USCS Graphic	Description	Analyses	Recovery	Collection Interval	Comments
0	ML		(0.0' - 0.4') SILT (ML); some Sand; some Gravel, <1"; 10YR4/2 dark grayish brown; loose; wet from surface; organics throughout.	WSAsb-027-5633-SO and MS/MSD collected from 0.0' - 1.0' on 03/23/10 at 1500 for TAL Metals + Hg, PAHs, and Explosives.	1.0'/1.0'		Soil Color Chart Munsell 2000 Rev. Ed.
1		(0.4' - 4.0') SILT (ML); some Clay; trace Sand lenses; 2.5Y6/6 olive yellow; medium stiff; dry to damp. Clay content increases with depth.	2.65'/3.0'				
2	ML			WSAsb-027-5634-SO collected from 1.0' - 4.0' on 03/23/10 at 1515 for TAL Metals + Hg, PAHs, and Explosives.			
4			(4.0' - 7.4') CLAY (CL); some Silt; trace Gravel, <1/2", subangular; Sand lenses throughout; 2.5Y5/4 light olive brown; stiff; damp; medium plasticity.	WSAsb-027-5635-SO collected from 4.0' - 7.0' on 03/24/10 at 1530 for TAL Metals + Hg, PAHs, and Explosives.	3.5'/3.0'		
5	CL		(6.5' - 7.4') Sand content increases with depth.				
7			(7.4' - 7.5') GRAVEL (GC); Sandy Clay matrix; 2.5Y5/4 light olive brown; wet.	WSAsb-027-5636-SO collected from 7.0' - 13.0' on 03/23/10 at 1545 for TAL Metals + Hg, PAHs, and Explosives.	3.0'/3.0'		
8	GC		(7.5' - 10.5') Fine grained SAND and CLAY (SC); little Silt; little 1/2" Gravel; 2.5Y5/4 light olive brown; dense; moist to wet; low plasticity.				
9	SC						
11			(10.5' - 13.0') Very fine and fine grained SAND (SW); trace fines; trace Gravel, <1/2", subangular; 2.5Y5/4 light olive brown; medium dense; dry.		3.5'/3.0'		
12	SW						
13			Boring terminated at 13.0 ft bgs.				Coordinate System: NAD 83

Boring backfilled with sodium bentonite chips and hydrated.
 0.0' - 1.0' sampled using a 3" hand auger and triangular subsample procedure for explosives as presented in Section 4.5.2.1.1 of the Facility-wide SAP.
 Samples were composited and homogenized for all analyses.

WSAsb-027

HTRW DRILLING LOG		DISTRICT USACE - Louisville	BOREHOLE NUMBER WSASB-028
1. COMPANY NAME SAIC		2. DRILLING SUBCONTRACTOR Frontz Drilling	
3. PROJECT RVAAP PBA DR RT		4. LOCATION RVAAP 8451 State Route 5 Ravenna, OH 44266	
5. NAME OF DRILLER JEREMY LECKRONE		6. MAKE/MODEL OF DRILL Geoprobe W20DT	
7. SIZES AND TYPES OF SAMPLING EQUIPMENT 3" x 1' HAND AUGER 1.5" x 4' ACETATE LINER 2" x 4' DUAL TUBE		8. BOREHOLE LOCATION N-558914.3195' E 2357007.9308	
		9. SURFACE ELEVATION/DATUM NAD 83	
		10. DRILL DATE/TIME 03/23/10	
		STARTED: 1207 COMPLETED: 1320	
		15. DEPTH GROUNDWATER ENCOUNTERED 10.3 FT	
		16. DEPTH TO WATER/ELAPSED TIME AFTER BOREHOLE COMPLETION NA	
12. OVERBURDEN THICKNESS 13+ FT			
13. DEPTH DRILLED INTO BEDROCK NA			
14. TOTAL DEPTH OF BOREHOLE 13 FT		17. OTHER WATER LEVEL MEASUREMENTS (INCLUDE DATE/TIME) NA	
18. GEOTECHNICAL SAMPLES UNDISTURBED: _____ DISTURBED: _____		19. TOTAL NUMBER OF CORE BOXES NA	
20. CHEMICAL SAMPLES CHEM: NES / PAH / VPC RAD: NA OTHER: _____		21. TOTAL CORE RECOVERY % NA	
22. DISPOSITION OF BOREHOLE DATE STARTED/INSTALLED: 03/23/10; 1207		DATE COMPLETED/ABANDONED: 03/23/10; 1320	
BACKFILL TYPE: <input type="checkbox"/> GROUT <input checked="" type="checkbox"/> BENTONITE <input type="checkbox"/> TEMPORARY WELL POINT <input type="checkbox"/> MONITORING WELL			
23. NOTES BKG: ≤ Background BGS: Below Ground Surface CPM: Counts per Minute PPM: Parts per Million ▽ : First Water Encountered ▼ : Static Water Level NA: Not Applicable			

LOCATION SKETCH/COMMENTS	SCALE: None
---------------------------------	--------------------

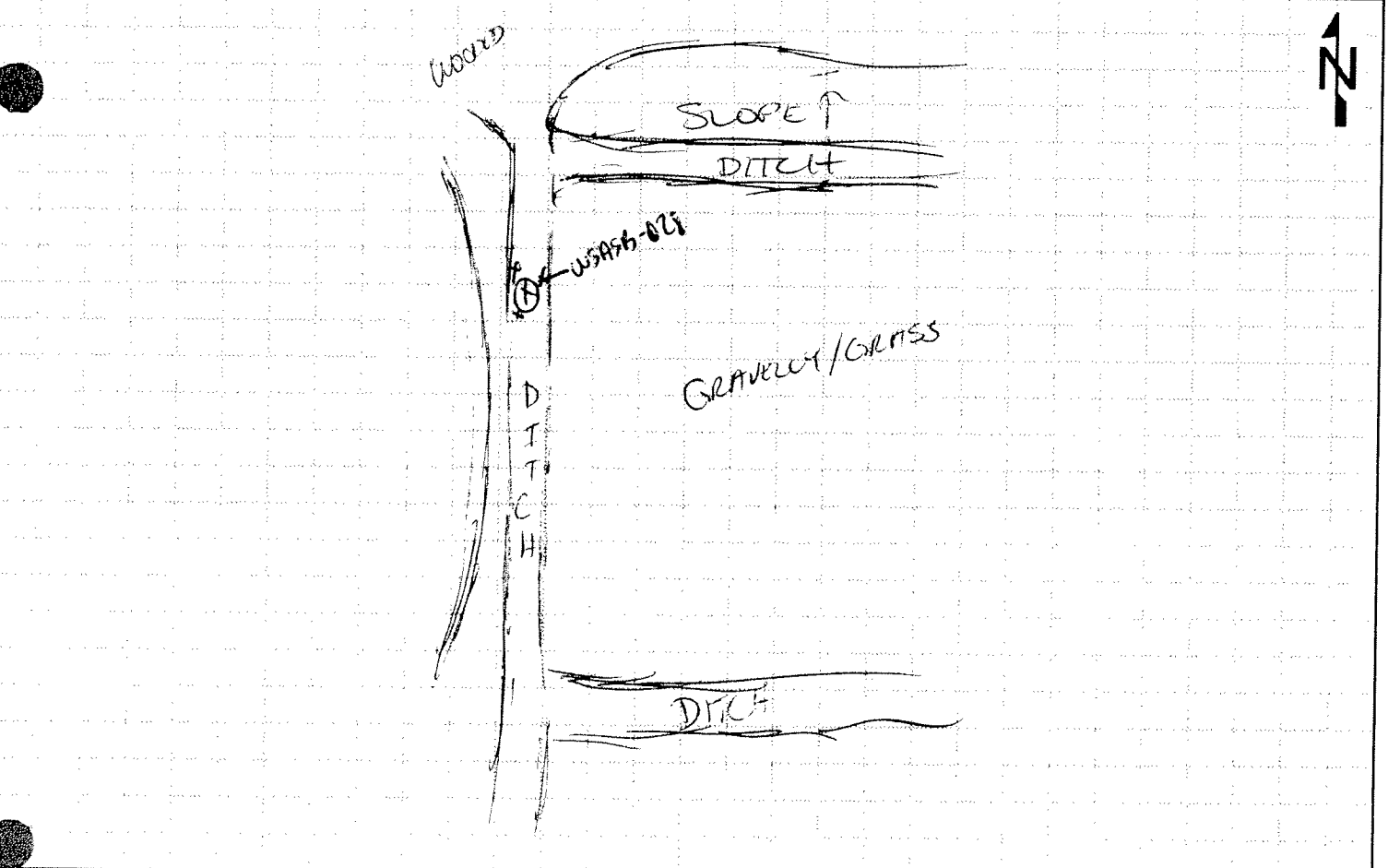

GEOLOGIST SIGNATURE/DATE Amanda Sention 03/23/10	QA/QC SIGNATURE/DATE RS 4/26/10	BOREHOLE NUMBER WSASB-028
---	------------------------------------	------------------------------



**RVAAP-45
Wet Storage Area
WSAsb-028**

Drilling Company : Frontz Drilling
 Driller : Jeremy Leckrone
 Designation of Drill : Geoprobe 6620DT
 Type of Drill Rig : Direct Push Technology
 Geologist : Amanda Trenton
 Oversight Company : SAIC
 Borehole Diameter : 2"
 Sampling Equipment : 1.5" x 4' Long Acetate Liner
 : 2" x 4' Dual Tube
 : 3" Hand Auger

RVAAP PBA 2008 Remedial Investigation
 Ravenna Army Ammunition Plant
 8451 State Route 5
 Ravenna, Ohio 44266
 Portage County

Start Date : 03/23/10; 1207
 End Date : 03/23/10; 1320
 Northing Coord. : 558916.3195
 Easting Coord. : 235007.9308
 Total Depth of Boring : 13.0'

Depth in feet	USCS Symbol	USCS Graphic	Description	Analyses	Recovery	Collection Interval	Comments
0	ML		(0.0' - 0.3') SILT (ML); some Clay; trace <1/4" Gravel; 10YR4/2 dark grayish brown; very soft; wet from surface water; high plasticity; organics throughout.	WSAsb-028-5637-SO collected from 0.0' - 1.0' on 03/23/10 at 1230 for VOCs, SVOCs, PCBs, Pesticides, Explosives, Propellants, and TAL Metals + Hg.	1.0'/1.0'		Soil Color Chart Munsell 2000 Rev. Ed.
1	ML		(0.3' - 0.7') SILT (ML); some Clay; 5Y5/1 gray, little 7.5Y5/8 strong brown; medium stiff; damp; low plasticity.				
2			(0.7' - 5.1') SILT and CLAY (ML/CL); 10YR5/6 yellowish brown and 5Y6/2 light olive gray; medium stiff; dry to damp; low plasticity.	2.7'/3.0'			
3	ML			WSAsb-028-5638-SO collected from 1.0' - 4.0' on 03/23/10 at 1240 for VOCs, SVOCs, PCBs, Pesticides, Explosives, Propellants, and TAL Metals + Hg.			
4							
5				WSAsb-028-5639-SO collected from 4.0' - 7.0' on 03/23/10 at 1305 for VOCs, SVOCs, PCBs, Pesticides, Explosives, Propellants, and TAL Metals + Hg.	3.1'/3.0'		
6	ML		(5.1' - 6.1') SILT (ML); 2.5Y5/4 light olive brown; medium dense; moist to wet.				
7			(6.1' - 8.3') SILT (ML); little Gravel and Shale; 2.5Y5/4 light olive brown; stiff; dry.				
8	ML						
9			(8.3' - 10.3') Fine grained SAND and SILT (SM); trace <1/2" Gravel; 10YR5/4 yellowish brown; moist to wet.	WSAsb-028-5640-SO collected from 7.0' - 13.0' on 03/23/10 at 1318 for VOCs, SVOCs, PCBs, Pesticides, Explosives, Propellants, and TAL Metals + Hg.	3.15'/3.0'		
10	SM		(9.2' - 10.3') Color is 2.5Y4/2 dark grayish brown.				
11			(10.3' - 11.85') SAND (SW); fine to coarse grained, coarsening downward; 10YR5/4 yellowish brown; medium dense; wet; nonplastic.	3.5'/3.0'			
12	SW						
13			(11.85' - 13.0') Fine grained SAND and SILT (SM); 10YR5/4 yellowish brown; medium dense; moist.				
			Boring terminated at 13.0 ft bgs.				Coordinate System: NAD 83

Boring backfilled with sodium bentonite chips and hydrated.
 0.0' - 1.0' sampled using a 3" hand auger and triangular subsample procedure for explosives as presented in Section 4.5.2.1.1 of the Facility-wide SAP.
 Samples were composited and homogenized for all analyses except VOCs.

WSAsb-028

HTRW DRILLING LOG		DISTRICT	BOREHOLE NUMBER
1. COMPANY NAME SAIC		USACE - Louisville	WSASB-029
2. DRILLING SUBCONTRACTOR Frontz Drilling		SHEET 1 OF 2	
3. PROJECT RVAAP PBA 08 RI		4. LOCATION RVAAP 8451 State Route 5 Ravenna, OH 44266	
5. NAME OF DRILLER JEREMY LUCKRONE		6. MAKE/MODEL OF DRILL Geoprobe NA	
7. SIZES AND TYPES OF SAMPLING EQUIPMENT 3" x 1' HAND AUGER		8. BOREHOLE LOCATION N 59° 07' 08.340" E - 23510 862.9209'	
		9. SURFACE ELEVATION/DATUM NAD 83	
		10. DRILL DATE/TIME 03/24/10 STARTED: 1110 COMPLETED: 1205	
		15. DEPTH GROUNDWATER ENCOUNTERED NA	
		16. DEPTH TO WATER/ELAPSED TIME AFTER BOREHOLE COMPLETION NA	
12. OVERBURDEN THICKNESS 7 FT		17. OTHER WATER LEVEL MEASUREMENTS (INCLUDE DATE/TIME) NA	
13. DEPTH DRILLED INTO BEDROCK NA			
14. TOTAL DEPTH OF BOREHOLE 7 FT			
18. GEOTECHNICAL SAMPLES UNDISTURBED: _____ DISTURBED: _____		19. TOTAL NUMBER OF CORE BOXES NA	
20. CHEMICAL SAMPLES CHEM: TUMT/QUALPAD: NA OTHER: _____		21. TOTAL CORE RECOVERY % NA	
22. DISPOSITION OF BOREHOLE DATE STARTED/INSTALLED: _____ DATE COMPLETED/ABANDONED: _____			
BACKFILL TYPE: <input type="checkbox"/> GROUT <input checked="" type="checkbox"/> BENTONITE <input type="checkbox"/> TEMPORARY WELL POINT <input type="checkbox"/> MONITORING WELL			
23. NOTES BKG: <input type="checkbox"/> Background BGS: <input type="checkbox"/> Below Ground Surface CPM: <input type="checkbox"/> Counts per Minute PPM: <input type="checkbox"/> Parts per Million ▽ : First Water Encountered ▼ : Static Water Level NA: Not Applicable			
LOCATION SKETCH/COMMENTS			SCALE: None
GEOLOGIST SIGNATURE/DATE Amanda Venton 03/24/10		QA/QC SIGNATURE/DATE RBM 04/26/10	
		BOREHOLE NUMBER WSASB-029	



**RVAAP-45
Wet Storage Area
WSAsb-029**

Drilling Company : Frontz Drilling
 Driller : Jeremy Leckrone
 Designation of Drill : NA
 Type of Drill Rig : NA
 Geologist : Amanda Trenton
 Oversight Company : SAIC
 Borehole Diameter : 3"
 Sampling Equipment : 3" Hand Auger

RVAAP PBA 2008 Remedial Investigation
 Ravenna Army Ammunition Plant
 8451 State Route 5
 Ravenna, Ohio 44266
 Portage County

Start Date : 03/24/10; 1110
 End Date : 03/24/10; 1205
 Northing Coord. : 559097.8346
 Easting Coord. : 2356862.9269
 Total Depth of Boring : 7.0'

Depth in feet	USCS Symbol	USCS Graphic	Description	Analyses	Recovery	Collection Interval	Comments
0	ML		(0.0' - 0.9') SILT (ML); some Sand; little Clay; trace Gravel; 10YR5/4 yellowish brown; damp; soft to medium dense; low plasticity; little roots/organics.	WSAsb-029-5641-SO collected from 0.0' - 1.0' on 03/24/10 at 1135 for TAL Metals + Hg, PAHs, and Explosives.	1.0'/1.0'		Soil Color Chart Munsell 2000 Rev. Ed.
1			(0.9' - 5.5') Very fine grained SAND (SM); some Silt; trace <1/2" gravel; 10YR5/4 yellowish brown; medium dense; damp in pockets. Silt content decreases with depth.	WSAsb-029-5642-SO collected from 1.0' - 4.0' on 03/24/10 at 1150 for TAL Metals + Hg, PAHs, and Explosives.	3.0'/3.0'		
5	SW		(5.5' - 7.0') Fine to medium grained SAND (SW); 10YR5/3 brown and 10YR6/3 pale brown; medium dense; dry to damp.	WSAsb-029-5643-SO collected from 4.0' - 7.0' on 03/24/10 at 1200 for TAL Metals + Hg, PAHs, and Explosives.	3.0'/3.0'		
7			Boring terminated at 7.0 ft bgs.				

Coordinate System: NAD 83

Boring backfilled with sodium bentonite chips and hydrated.
 0.0' - 1.0' sampled using a 3" hand auger and triangular subsample procedure for explosives as presented in Section 4.5.2.1.1 of the Facility-wide SAP.
 Samples were composited and homogenized for all analyses.

WSAsb-029

THIS PAGE INTENTIONALLY LEFT BLANK.

SURFACE WATER AND SEDIMENT SAMPLES

THIS PAGE INTENTIONALLY LEFT BLANK.



RVAAP - Surface Water & Wet Sediment Field Form

SHEET 1 OF 1

USACE - Louisville
RVAAP PBA 2008 RIRVAAP 8451 State Rt. 5
Ravenna, OH 442661. Sample Team: SARA HISE
RICH SPRINZL

2. Location ID: WSA sw/sd - 037

3. Revised Coordinates Recorded: N 55°08'1.423" E 2356.116.004'

4. Surface Water Sample ID: WSA SW - 037 - 5656 - SW

5. Date and Time: 03/23/10, 1400

6. Dupe ID (if needed): N/A

7. Split ID (if needed): N/A

8. Surface Water Sample Type and Equipment Used: GRAB, NO SPECIAL EQUIP.

9. MS/MSD: N/A

10. Wet Sediment Sample ID: WSA sd - 037 - 5649 - SD

11. Date and Time: 03/23/10, 1005

12. Dupe ID (if needed): N/A

13. Split ID (if needed): N/A

14. Wet Sediment Sample Type and Equipment Used: GRAB, PUSH PROBE, TROWEL

15. MS/MSD: N/A

16. Weather Conditions: 36°F, SLIGHT BREEZE, LIGHT RAIN

17. Activities in the Area: NONE

LOCATION SKETCH/COMMENTS

SCALE: None

Field Notes: STREAM IS CLEAR, GRAVELLY BOTTOM W/SOME BRANCHES. A FEW BUBBLES ON SURFACE, MODERATE FLOW

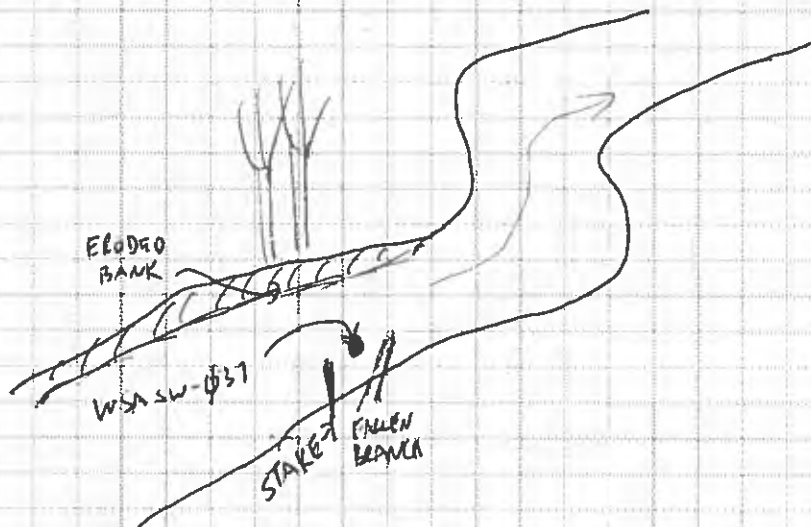

FIELD MEASUREMENTS	READING	UNITS	SERIAL NO.	LAST CALIB.
TEMPERATURE:	<u>6.54</u>	°C	<u>155704</u>	<u>03/23/10</u>
pH:	<u>7.74</u>	S.U.		
CONDUCTIVITY:	<u>0.186</u>	mS/cm		
DO:	<u>10.249</u>	mg/L		
TURBIDITY:	<u>0.14</u>	NTU	<u>15557</u>	
OTHER				

SURFACE WATER ANALYSES:

- EXPLOSIVES TAL METALS SVOCs OTHER _____
 FULL SUITE (VOCs, SVOCs, Metals, Explosives, Propellants, Pesticides, PCBs)

WET SEDIMENT ANALYSES:

- EXPLOSIVES TAL METALS SVOCs OTHER _____
 FULL SUITE (VOCs, SVOCs, Metals, Explosives, Propellants, Pesticides, PCBs)

Recorded By:

Sara J. Hise
(Signature and Date)

QC Checked by:

[Signature] 03/31/2010
(Signature and Date)



RVAAP - Surface Water & Wet Sediment Field Form

SHEET 1 OF 1

USACE - Louisville

RVAAP 8451 State Rt. 5
Ravenna, OH 44266

1. Sample Team: RICH SPRINZL

RVAAP PBA 2008 RI

SARA HISE

2. Location ID:

WSA sw/rd - 038

3. Revised Coordinates Recorded:

NORTHING: 559 717.33, EAST: 235 6587.40

4. Surface Water Sample ID:

WSA SW - 038 - 5657 - SW

5. Date and Time:

03/23/10, 1140

6. Dupe ID (if needed):

N/A

7. Split ID (if needed):

N/A

8. Surface Water Sample Type and Equipment Used: DIRECT FILL

9. MS/MSD: N/A

10. Wet Sediment Sample ID:

WSA rd - 038 - 5657 - SD

11. Date and Time:

03/23/10, 1145

12. Dupe ID (if needed):

N/A

13. Split ID (if needed):

N/A

14. Wet Sediment Sample Type and Equipment Used: SS BOWL AND PUSH PROBE

15. MS/MSD: N/A

16. Weather Conditions: 40°F, CLOUDY, SCATTERED RAIN 17. Activities in the Area: NONE

LOCATION SKETCH/COMMENTS

SCALE: None

Field Notes: WATER IS CLEAR,
FAST FLOW, ~1' DEEP,
GRAVELLY/ROCKY BOTTOM
LOCATION MOVED TO CAPTURE
BOTH STREAM FLOWS.

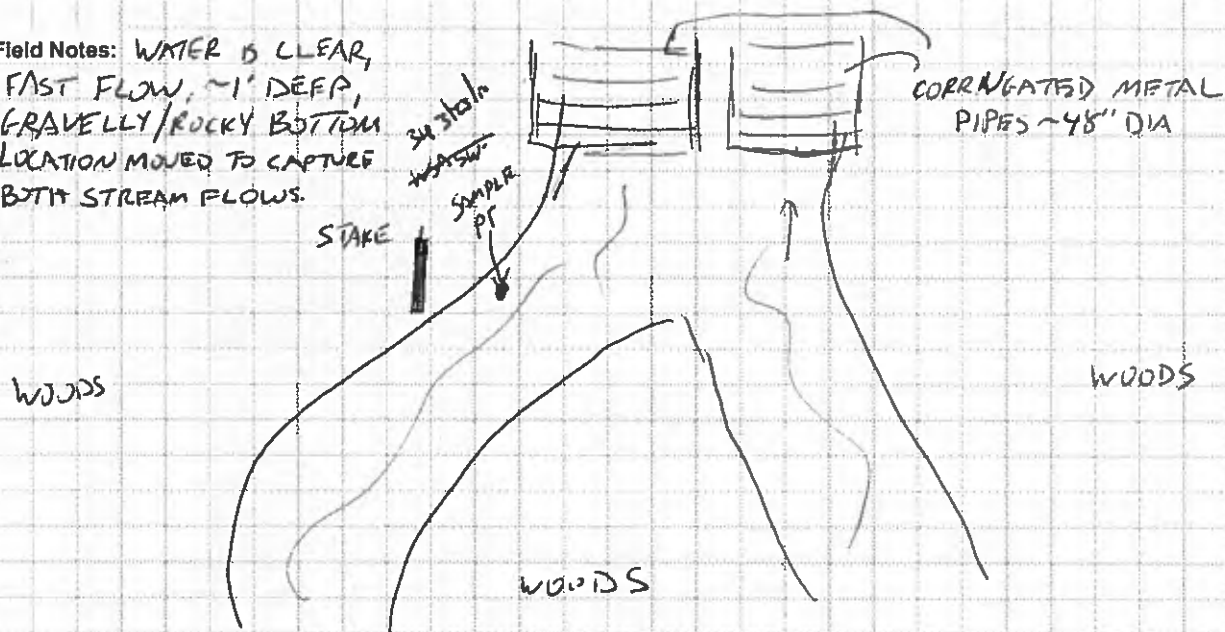

FIELD MEASUREMENTS	READING	UNITS	SERIAL NO.	LAST CALIB.
TEMPERATURE:	6.93	°C	15560	03/23/10
pH:	8.01	S.U	↓	↓
CONDUCTIVITY:	0.166	mS/cm	↓	↓
DO:	10.51	mg/L	↓	↓
TURBIDITY:	7.79	NTU	15557	↓
OTHER:				

SURFACE WATER ANALYSES:

- EXPLOSIVES TAL METALS SVOCs OTHER _____
 FULL SUITE (VOCs, SVOCs, Metals, Explosives, Propellants, Pesticides, PCBs)

WET SEDIMENT ANALYSES:

- EXPLOSIVES TAL METALS SVOCs OTHER _____
 FULL SUITE (VOCs, SVOCs, Metals, Explosives, Propellants, Pesticides, PCBs)

Recorded By:

S. L. Nair 03/23/10
(Signature and Date)

QC Checked by:

[Signature] 03/31/2010
(Signature and Date)



RVAAP - Surface Water & Wet Sediment Field Form

SHEET 1 OF 1

USACE - Louisville

RVAAP 8451 State Rt. 5
Ravenna, OH 442661. Sample Team: RICH STRIDEL JR #3110
SARA HISE, RYAN LAURICH

2. Location ID: <u>WSA_{sd}/sw - 039</u>		3. Revised Coordinates Recorded: <u>NONE</u>	
4. Surface Water Sample ID: <u>WSA_{sw} - 039-5658-SW</u>		5. Date and Time: <u>03/23/14, 1504</u>	
6. Dupe ID (if needed): <u>NA</u>		7. Split ID (if needed): <u>NA</u>	
8. Surface Water Sample Type and Equipment Used: <u>DIRECT FILL</u>			9. MS/MSD: <u>NA</u>
10. Wet Sediment Sample ID: <u>WSA_{sd} - 039-5651-SD</u>		11. Date and Time: <u>03/23/14, 1515</u>	
12. Dupe ID (if needed): <u>NA</u>		13. Split ID (if needed): <u>NA</u>	
14. Wet Sediment Sample Type and Equipment Used: <u>SS BOWL AND PUSH PROBE</u>			15. MS/MSD: <u>NA</u>
16. Weather Conditions: <u>41°F - CLOUDY</u>		17. Activities in the Area: <u>NONE</u>	

LOCATION SKETCH/COMMENTS

SCALE: None

Field Notes: FAST FLOW, RICKY BOTTOM, CLEAR
SOME BUBBLES ON SURFACE SOME GREEN
ALGAE ON ROCKS

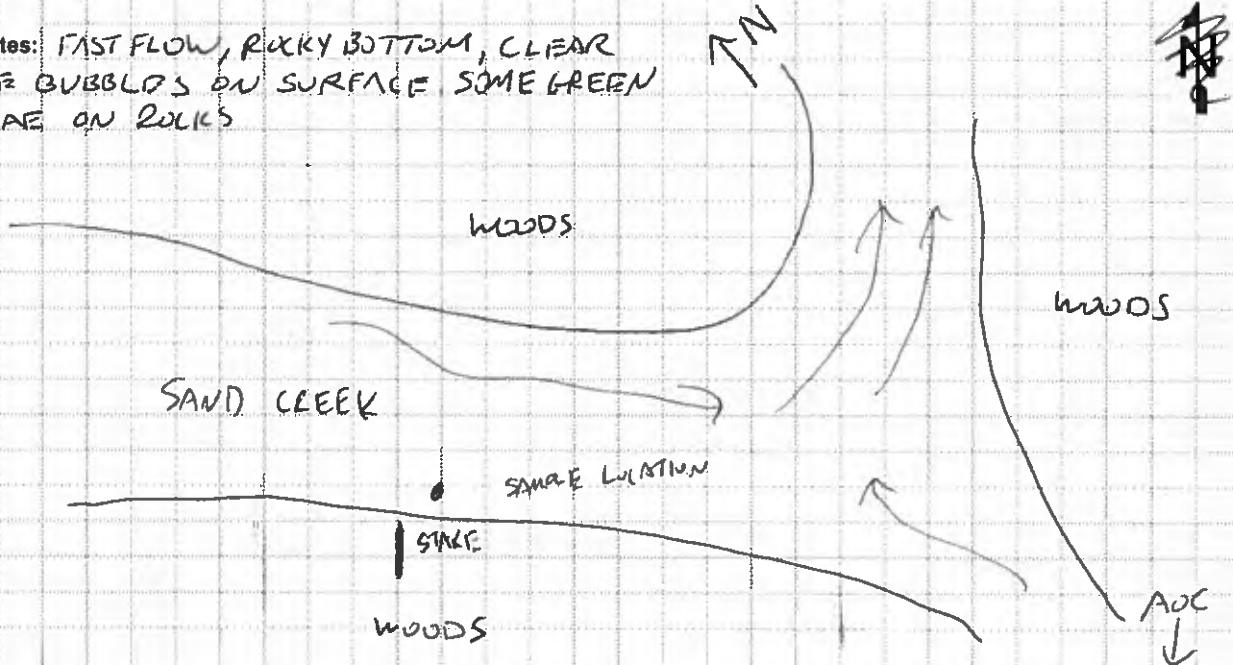

FIELD MEASUREMENTS	READING	UNITS	SERIAL NO.	LAST CALIB.
TEMPERATURE:	6.64	°C	15560	03/23/14
pH:	7.73	S.U	↓	↓
CONDUCTIVITY:	0.113	mS/cm		
DO:	10.47	mg/L	↓	↓
TURBIDITY:	20.3	NTU		
OTHER:				

SURFACE WATER ANALYSES:

- EXPLOSIVES TAL METALS SVOCs OTHER _____
 FULL SUITE (VOCs, SVOCs, Metals, Explosives, Propellants, Pesticides, PCBs)

WET SEDIMENT ANALYSES:

- EXPLOSIVES TAL METALS SVOCs OTHER _____
 FULL SUITE (VOCs, SVOCs, Metals, Explosives, Propellants, Pesticides, PCBs)

Recorded By:

S. / H. 03/23/14
(Signature and Date)

QC Checked by:

[Signature] 03/23/14
(Signature and Date)



RVAAP - Surface Water & Wet Sediment Field Form

SHEET 1 OF 1

USACE - Louisville

RVAAP 8451 State Rt. 5
Ravenna, OH 44266

1. Sample Team: Rich Sprinzl

Steve Visocky
Heather Miller (FM)

2. Location ID:

WSA_{sw} - 040

3. Revised Coordinates Recorded:

NA

4. Surface Water Sample ID:

WSA_{sw} - 040

5. Date and Time:

3/31/10 1130

6. Dupe ID (if needed):

WSA_{sw} - 040 - 6198 - FD

7. Split ID (if needed):

WSA_{sw} - 040 - 6198 - QA

8. Surface Water Sample Type and Equipment Used:

Direct Fill

9. MS/MSD: NA

10. Wet Sediment Sample ID:

WSA_{sd} - 040

11. Date and Time:

3/30/10 1130

12. Dupe ID (if needed):

NA

13. Split ID (if needed):

NA

14. Wet Sediment Sample Type and Equipment Used:

SS bowl + spoon

15. MS/MSD: NA

16. Weather Conditions:

Sunny 38 F

17. Activities in the Area:

none

LOCATION SKETCH/COMMENTS

SCALE: None

Field Notes:

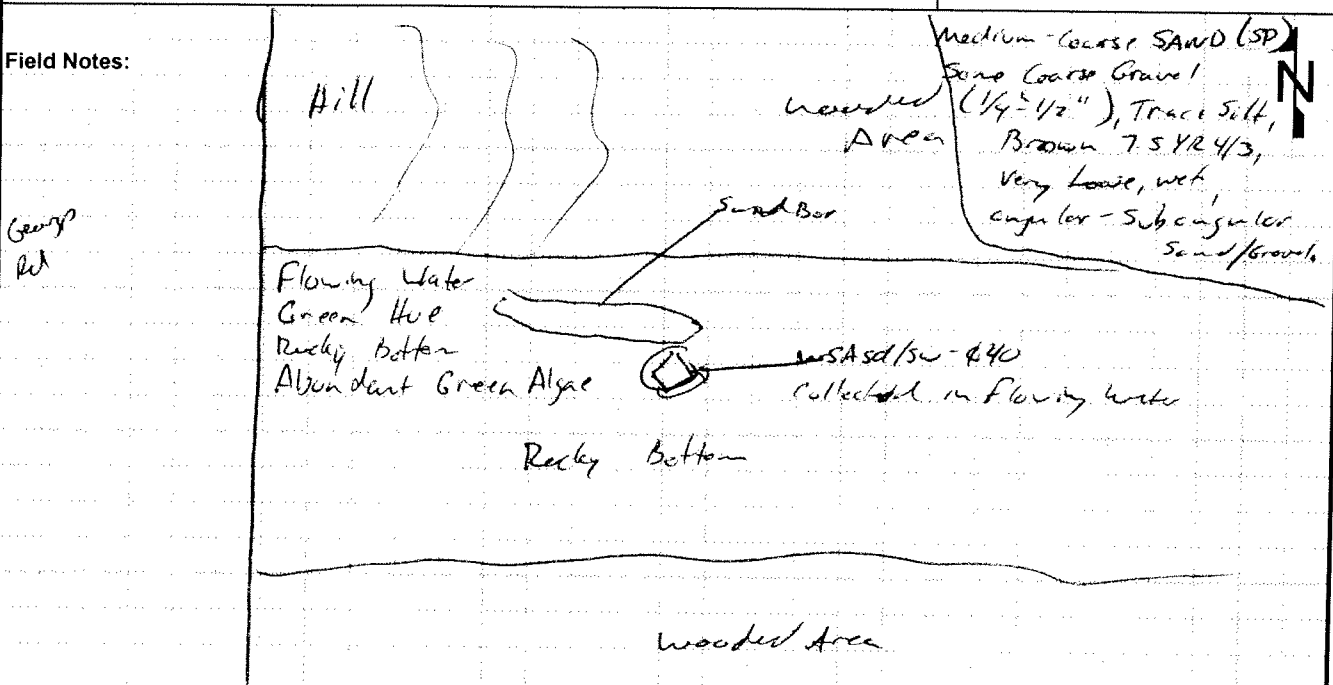

FIELD MEASUREMENTS	READING	UNITS	SERIAL NO.	LAST CALIB.
TEMPERATURE:	6.28	°C	15558	3/30/10
pH:	7.42	S.U	↓	↓
CONDUCTIVITY:	164	mS/cm	↓	↓
DO:	11.46	mg/L	↓	↓
TURBIDITY:	6.02	NTU	15557	↓
OTHER _____				

SURFACE WATER

ANALYSES:

- EXPLOSIVES TAL METALS SVOCs OTHER _____
 FULL SUITE (VOCs, SVOCs, Metals, Explosives, Propellants, Pesticides, PCBs)

WET SEDIMENT

ANALYSES:

- EXPLOSIVES TAL METALS SVOCs OTHER _____
 FULL SUITE (VOCs, SVOCs, Metals, Explosives, Propellants, Pesticides, PCBs)

Recorded By:

 (Signature and Date) 3/31/10

QC Checked by:

 (Signature and Date) 3/31/10