

APPENDIX D.
Professional Survey Report

RAVENNA ARMY AMMUNITION PLANT
 KS PROJECT NO. 08355 BG 001
 COMMENTS: OBSERVATIONS (4/10/09) OBSERVER: RAC
 INSTRUMENT TYPE: TRIMBLE 5800 - VRS
 WEATHER: RAIN 48°

KS ASSOCIATES
 Civil Engineers + Surveyors
 260 Burns Road, Suite 100
 Elyria, OH 44035
 440 365 4730

POINT NO	OHIO STATE PLANE	OHIO STATE PLANE	NAVD 88 ELEVATION	NGVD 29 ELEVATION	DESC
	NAD83(2007) NORTHING	NAD83(2007) EASTING			
2012	554768.85	2353178.88	1117.99	1118.53	PAD SCF MW-001
2013	554768.62	2353178.98	1120.17	1120.71	TOP CASING SCF MW-001
2010	555152.13	2368927.16	981.74	982.28	PAD SCF MW-002
2011	555152.38	2368927.36	984.02	984.56	TOP CASING SCF MW-002
2008	557957.93	2375843.24	955.59	956.14	PAD SCF MW-003
2009	557957.67	2375843.20	957.92	958.47	TOP CASING SCF MW-003
2006	560361.40	2378730.26	941.32	941.87	PAD SCF MW-004
2007	560361.03	2378730.23	943.62	944.17	TOP CASING SCF MW-004
2004	567302.34	2377014.40	957.89	958.43	PAD SCF MW-005
2005	567302.35	2377014.05	960.26	960.80	TOP CASING SCF MW-005
2000	569583.80	2369394.56	963.15	963.69	PAD SCF MW-006
2001	569583.41	2369394.54	965.38	965.92	TOP CASING SCF MW-006

Trevor A. Bixler 4-13-09

Trevor A. Bixler, P.S. Date
 Professional Surveyor, Ohio No. 7730

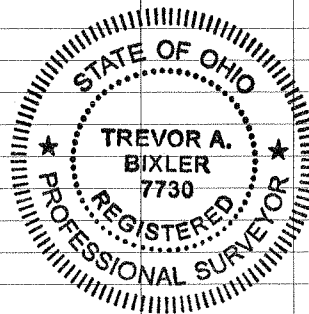



TASK TEAM ACTIVITY LOG SHEET

Date (mm/dd/yy): 04/10/09 Su M Tu W Th **F** Sa PAGE 1 OF 3

Task Team Members:

AMANDA TRENTON; SAIC

RICK C.; KS ASSOCIATES

Narrative (include time and location):

0754 AMANDA ARRIVES ONSITE; DROPS SUPPLIES OFF FOR PIKA

0800 COMPLETE FRAC 1 WEEKLY VISUAL INSPECTION

0806 CONFIRM DUMPSTER @ BLDG 1036 WAS EMPTIED (DUMPSTER IS EMPTY)

CLEANED UP GENERAL AREA BY DUMPSTER WHERE TRASH HAD BLOWN OUT OF DUMPSTER.

0826 KS ASSOCIATES ARRIVE ONSITE; HOLD DAILY TAILGATE SAFETY BRIEFING

0849 ARRIVE AT SCFMW-006; SURVEY MEASUREMENTS WILL BE COLLECTED ON PAD BY PROTECTIVE CASING (N SIDE) + TOP OF CASING WILL BE COLLECTED ~~ON~~ ^{ON} ETCHED NORTH

0905 DEPART SCFMW-006 FOR SCFMW-005 - WILL RETURN TO 006 FOR 2nd MEASUREMENT (COLLECTED FOR ACCURACY)

0913 ARRIVE AT SCFMW-005 - COLLECT SURVEY MEASUREMENTS WILL RETURN FOR 2nd MEASUREMENT - FEW SATELLITES CURRENTLY.

0934 DEPART SCFMW-005 FOR SCFMW-006

Daily Weather Conditions: A.M. 40 F; overcast; rain

P.M. 44 F; overcast; rain

Recorded By Amanda Trenton

QA Checked By Emily Cunningham



TASK TEAM ACTIVITY LOG SHEET

Date (mm/dd/yy): 04/10/09 Su M Tu W Th F Sa PAGE 2 OF 3

Task Team Members:

AMANDA TRENTON; SAIC
RICK C; KS ASSOCIATES

Narrative (include time and location):

- 0939 ARRIVE AT SCFMW-006; COLLECT 2nd SET OF MEASUREMENTS
- 0945 DEPART SCFMW-006 - HEAD TO SCFMW-004
- 0954 ARRIVE SCFMW-004 - COLLECT 2 SETS OF MEASUREMENTS
- 1014 DEPART SCFMW-004 FOR SCFMW-003
- 1018 ARRIVE AT SCFMW-003 - COLLECT TWO SETS OF MEASUREMENTS
- 1044 DEPART SCFMW-003 FOR SCFMW-005
- 1050 ARRIVE AT SCFMW-005 - COLLECT 2nd SET OF MEASUREMENTS
- 1057 DEPART SCFMW-005 FOR SCFMW-002
- 1100 FRAC 2 INSPECTION (WEEKLY VISUAL INSPECTION)
- 1105 ARRIVE AT SCFMW-002 - COLLECT 2 SETS OF MEASUREMENTS
- 1117 DEPART SCFMW-002
- 1121 ARRIVE AT RAV 10 ^{SURVEY MARKER} (INTERSECTION OF PARIS WINDHAM + SOUTH SERVICE)
- 1127 DEPART RAV 10 SURVEY MARKER
- 1132 COLLECT RAV 2 SURVEY MARKER LOCATION (INTERSECTION OF NEWTON FALLS + GEORGE)
- 1141 ARRIVE AT SCFMW-001 - COLLECT 2 SETS OF MEASUREMENTS

Daily Weather Conditions: A.M. 40°F; overcast; rain
P.M. 44°F; overcast; rain

Recorded By Amanda Trenton

QA Checked By Emily Cunningham



TASK TEAM ACTIVITY LOG SHEET

Date (mm/dd/yy): 04/10/09 Su M Tu W Th **F** Sa PAGE 3 OF 3

Task Team Members:

AMANDA TRENTON; SAIC
RICK C; KS ASSOCIATES

Narrative (include time and location):

1156 DEPART SCFmw-001 FOR POST 1/BLDG 1038
1202 KS ASSOCIATES DEPART SITE
1213 COMPLETE FRAC 3 VISUAL INSPECTION
1218 COMPLETE CENTRAL BURN PITS SILT FENCE INSPECTION
1227 SAIC DEPARTS SITE. END OF DAY.

~~_____

_____~~

~~Am
04/10/09~~

Daily Weather Conditions: A.M. 40°F; overcast; rain

P.M. 44°F; overcast; rain

Recorded By Amanda Trenton

QA Checked By Emily Cunningham